

2012-13 Catalogue // Profile



*Urban*

*fountains + furniture*



# Index

index	2
company	3
delivering what counts	4
custom design	5
quality furniture	6
vandalism resilience & adaptability	7
sustainable practices	8
drinking fountains	9
bench seats	23
bins	36
outdoor showers	42
picnic tables	45
dog play equipment	50
balustrading	59
tree grates	61
porous paving	69
bike racks	70
contact urbanff	72



# Company

Urban specialises in working with councils to provide you with a range of high quality, durable and locally produced street furniture for use in your projects. We can also design and supply custom-made furniture to your specifications.

Over the years, our focus has always been on providing a good product, but also making the lives of our specifiers and design partners easier. Working with us ensures you a smooth design process where your concepts are translated to reality with a minimum of hassles.

By manufacturing in-house locally in our Queensland facility rather than sending the job offshore, we also give you the peace of mind that you are specifying a product that will deliver, and keep delivering.

Urban Fountains and Furniture is a family owned and operated business, and is managed by proprietors Gary and Claire Allan.

When you deal with Urban, you can be assured that you will be supplied with high quality, yet reasonably priced street furniture, accompanied by a high level of personalised service. We pride ourselves on always delivering high quality products every time, on time.

At the end of the day, we value and encourage close working relationships with our clients and truly enjoy helping them create new & exciting urban landscapes.



# Delivering What Counts



**Reliability** Your deadlines will be met, because we simply deliver products on time and do everything we say that we are going to do.

**Practicality** Our tradesmen have many years experience and know which designs and ideas will work best to help you achieve what you want.



**Flexibility** Because we are the manufacturer, we can alter anything to your requirements and work within whatever constraints you may have.

**Efficiency** Whether your project is small and simple or large and complicated, we are structured to appropriately prioritise your job according to your needs.

**Understanding** You want a high quality product at a reasonable price within a reasonable time. We understand that and will support you to make it happen.

**Passion** With Urban you are working with a team of people that are passionate about what we do, and take pride in doing it well.

**High Quality** All our products are made to the highest possible standard. We use only first grade materials and professional staff and tradespeople.

**Competitive Pricing** We deliver at a very good price because we are the manufacturer. There is no "middle man" taking his cut, so you reap the savings.



# Custom Design

You will benefit from Urban's full custom design service that allows close consultation between you and our in-house design and manufacturing team.

You are able to concentrate on the important aspects of your project because we are able to help you reach a practical working solution to your unique design concepts. We can work within many design, budget or time constraints that may be enforced on a project or development, and see our role as to simply help you get the job done with the best result for the client.

Our team are able to offer advice on any alternative use of materials, fixings and finishes that may result in a more practical or economical item without compromising the final quality, functionality or aesthetics of the finished product.

We can help you through every step of the process to final manufacture and delivery by working with you using the latest 3D Auto CAD technology. This makes it far easier when planning the overall look and functionality of a given job because it brings graphic visualisation to your concepts.

We can also provide scale models and prototypes ahead of production. Our approach allows our clients to be involved as much or as little they want.

Some customers know exactly what they want so we provide an engineering advisory role regarding different materials or variations to design that may result in increased functionality or cost savings.

Other clients tell us what look or function they require and perhaps what budget they have and we will come up with some designs for them to approve or alter.

We offer stage by stage consultation and feedback, but the intricacy of the process is up to you and is dependent on the complexity of the job.

Additionally, all of our standard product range can be modified to suit your application. As the manufacturer of these products we are able to alter dimensions, substitute different materials or add/remove components from any item as desired.



Hayman Island Gabions  
for Jamie Durie Designs

# Quality Furniture

Urban's manufacturing facilities have a fully equipped general engineering workshop and in-house gravity die casting facilities.

This allows you to reap the benefits of dealing with a supplier that is able to exercise an extremely high level of quality control as all key stages of the manufacturing process are conducted in-house. The products are built to be extremely durable so they'll look good for a long time, not just when they leave the factory.

Due to our flexible approach to manufacturing, we are able to accommodate you if you want to get alterations or modifications made to any listed product.

If your job is of a high priority due to a tight delivery timeframe, we are able to fast-track those jobs if required. You also have the peace of mind of knowing that you are kept fully informed as to the status of your job at any given time.

Not least importantly, Urban is able to keep costs competitive because we do not outsource to subcontractors.



Macquarie One, Tenerife

# Vandalism Resilience + Adaptability

You are assured that any furniture provided by Urban has been manufactured to provide an industry leading level of quality. Our extensive experience in manufacturing strong and durable furniture means you will not only receive attractive and functional furniture, but will benefit from ongoing lower maintenance and repair costs.

Outdoor furniture will always be the subject of mindless vandalism and graffiti, but there are ways to minimize the impacts of such actions. By utilizing high-grade concretes and steel in our designs, Urban's furniture is virtually indestructible meaning the potential damage caused by fires or vandalism is greatly reduced.

We install as many fittings and fixtures as possible internally in the furniture so that they cannot be accessed and damaged.

Furniture components cannot be pulled apart and the furniture itself is heavy and not able to be easily removed. Any external visible fixtures and fittings that are necessary are locked with security screws or chemset bolts.

Urban can also include Rapelle graffiti coatings, suitable as an anti-graffiti shield to further cut ongoing maintenance costs.

All of these design features ensure that Urban products are durable and resilient enough to be used in high-use environments as well as your more remote locations.

The bottom line is that Urban's designs are stylish and robust enough to deliver both aesthetically and functionally.

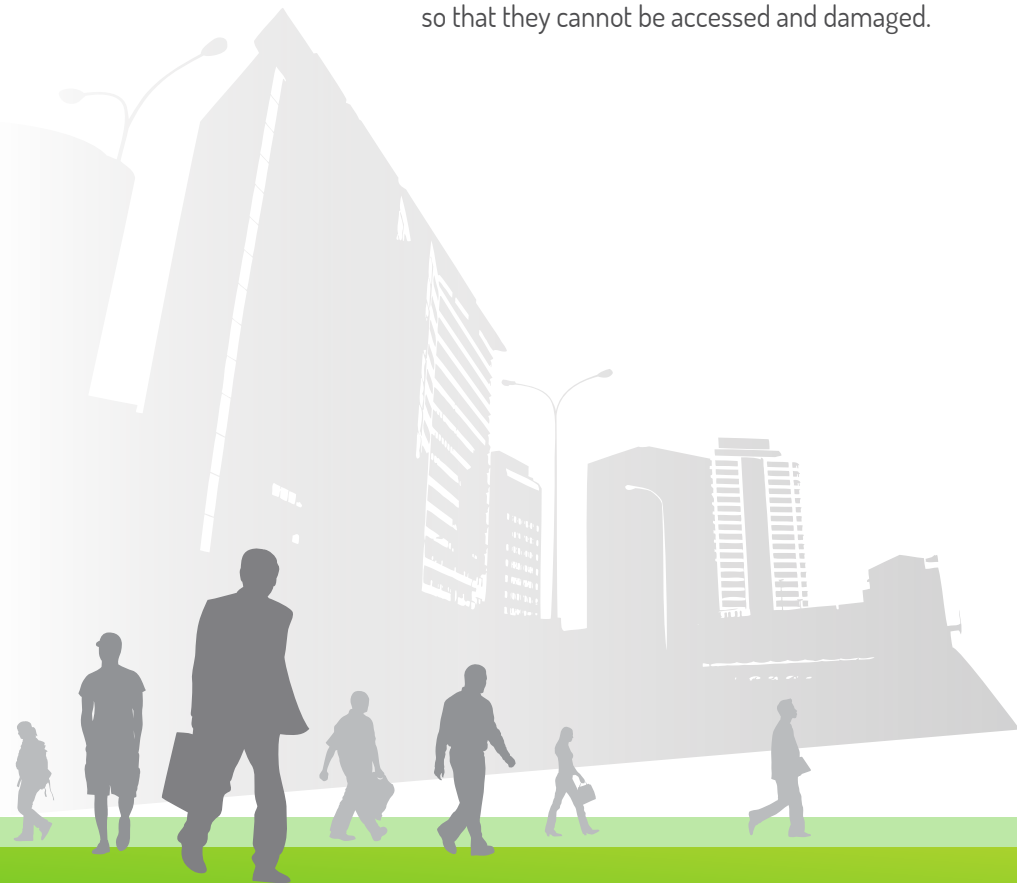

# Sustainable Development

Urban takes a holistic approach to proactively reduce waste and promote sustainability. This means that sustainable initiatives are prevalent throughout our company culture and extend through to our choices of suppliers and partners. We realise that in order for our business to be sustainable, environmentally friendly and ethical practices are vital areas of development.

Initially, our focus is on reducing waste during our manufacturing process. Materials are carefully chosen on ordering and cut/fabricated in ways developed to minimise wastage. Recycled plastics and timber are also offered as alternative components in all of our furniture. These materials are sourced only through rainforest alliance certified traders that are proven to be environmentally friendly and are involved in re-forestation programmes.

All materials from steel, stainless, aluminium and timber that are unable to be further utilized are recycled through local reputable companies. Similarly accredited and reputable companies also handle the recycling of any packaging materials, cardboards and plastics used. All consumable products that cannot be recycled are disposed of considerately and according to Council regulations.



We have recently relocated to a new manufacturing facility built to further comply with regulatory guidelines and recommendations for energy efficiency and conservation. The installation of water tanks and water saving devices in bathrooms and wash bays, and the preference for energy efficient lighting through all offices are just some of the initiatives that form our commitment. The workshop skylights have also enabled us to eliminate the use of harmful mercury lamps for our lighting requirements.

Through these improved factory and manufacturing practices not only have we been able to reduce our environmental impact, but also create key cost benefits that can be passed on to our clients.



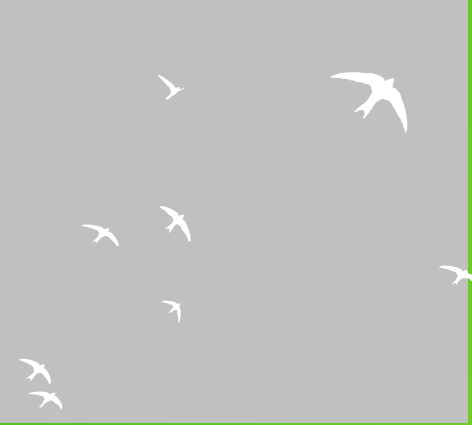

# Products // Drinking Fountains

# Drinking Fountain: Apollo 300

The Apollo 300 is a durable, vandal resistant outdoor disabled accessible fountain. It is just one of our fountains in the Apollo range designed for disabled access.

- Dimensions**
- Total Height: 835mm
  - Clearance Height: 735mm
  - 200mm x 100mm RHS steel
  - One piece heavy duty construction
- Finishes**
- Hot dipped galvanised prior to coating
  - Primed and 2 pak epoxy wet spray finish
  - Available in many different colours. [See colour selector](#)
  - All fountains come with vandal resistant 316 stainless steel security screws.
- Plumbing**
- In built water pressure regulator ½' inlet
  - 40mm Waste outlet pipe
- Options**
- Optional tap available
  - Dog water bowl available
  - [Optional wall mounted](#)
  - Full parts and technical back up service available.
  - Service kits available for purchase.

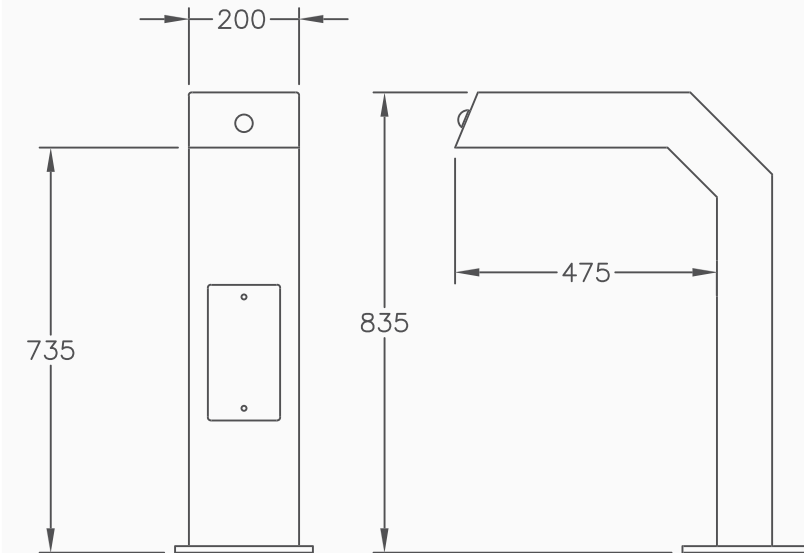

[Click to view the latest Apollo 300 projects online](#)



Get the latest specification news on



[www.urbanff.com.au](http://www.urbanff.com.au)

07 3382 7372

[info@urbanff.com.au](mailto:info@urbanff.com.au)

*Urban*  
fountains + furniture

# Drinking Fountain: Apollo 300w

The Apollo 300w is a durable, vandal resistant wall mounted outdoor disabled accessible fountain. It is just one of our fountains in the Apollo range designed for disabled access.

- Dimensions**
- Total Height: Variable to suit
  - Clearance Height: Variable to suit
  - 200mm x 100mm RHS steel
  - One piece heavy duty construction
- Finishes**
- Hot dipped galvanised prior to coating
  - Primed and 2 pak epoxy wet spray finish
  - Available in many different colours. [See colour selector](#)
  - All fountains come with vandal resistant 316 stainless steel security screws.
- Plumbing**
- In built water pressure regulator ½' inlet
  - 40mm Waste outlet pipe
- Options**
- [Optional standard Apollo 300 surface mounted](#)
  - Full parts and technical back up service available.
  - Service kits available for purchase.

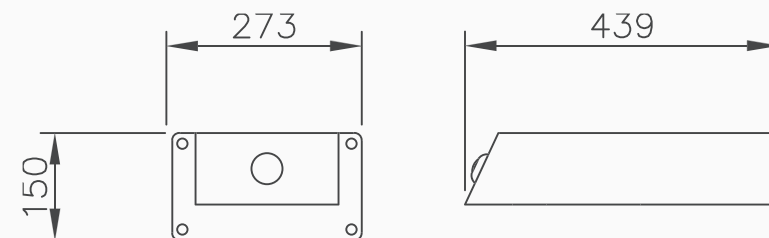

[Click to view the latest Apollo 300w projects online](#)

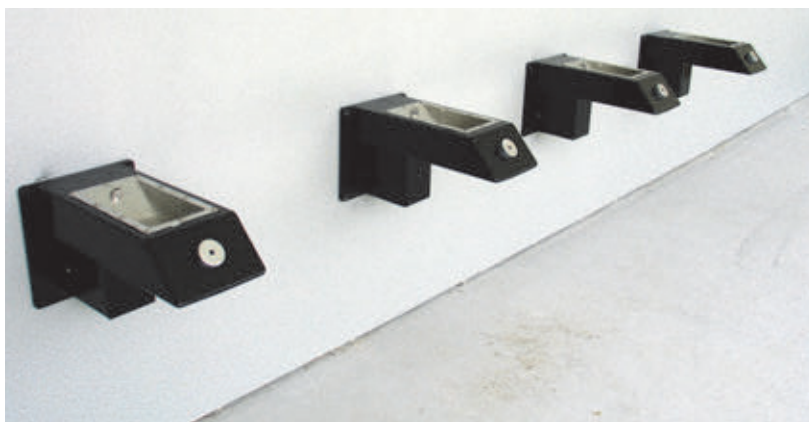

Get the latest specification news on



[www.urbanff.com.au](http://www.urbanff.com.au)

07 3382 7372

[info@urbanff.com.au](mailto:info@urbanff.com.au)

*Urban*  
fountains + furniture

# Drinking Fountain: Apollo 400

The Apollo 400 is a durable, vandal resistant outdoor disabled accessible fountain. It is just one of our fountains in the Apollo range designed for disabled access.

- Dimensions**
- Total Height: 845mm
  - Clearance Height: 680mm
  - 165 OD Steel Pipe
  - One piece heavy duty construction
- Finishes**
- Hot dipped galvanised prior to coating
  - Primed and 2 pak epoxy wet spray finish
  - Available in many different colours. [See colour selector](#)
  - All fountains come with vandal resistant 316 stainless steel security screws
- Plumbing**
- In built water pressure regulator ½' inlet
  - 40mm Waste outlet pipe
- Options**
- Optional tap available
  - Full parts and technical back up service available.
  - Service kits available for purchase
  - Button activated
  - Dog Bowl

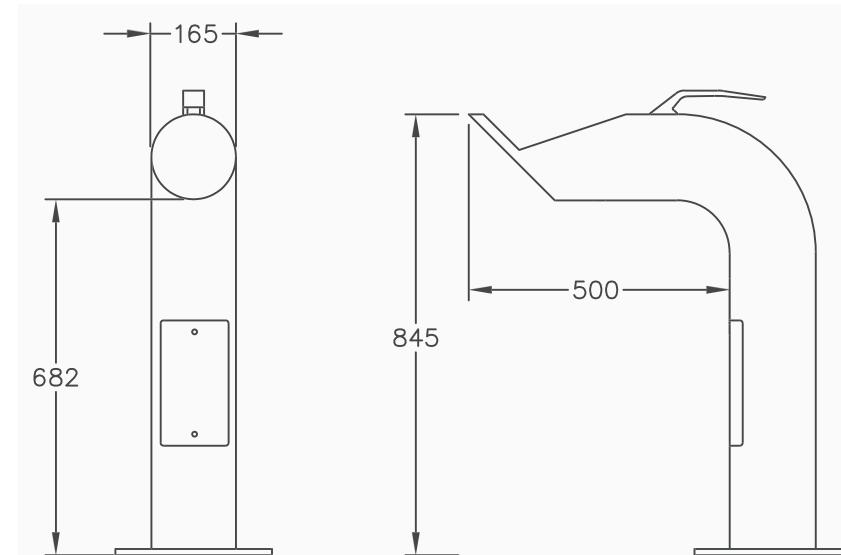

[Click to view the latest Apollo 400 projects online](#)



Get the latest specification news on



[www.urbanff.com.au](http://www.urbanff.com.au)

07 3382 7372

[info@urbanff.com.au](mailto:info@urbanff.com.au)

*Urban*  
fountains + furniture

# Drinking Fountain: Apollo 600

The Apollo 600 is a durable, vandal resistant Stainless Steel outdoor disabled accessible fountain. It is just one of our fountains in the Apollo range designed for disabled access. The Apollo 600 is a strong, robust and practical fountain.

## Dimensions

- Total Height: 960mm
- Clearance Height: 750mm
- 165 OD steel pipe
- One piece heavy duty construction

## Water Receptacle

- 275 OD - 316 stainless steel electropolished basin
- Nozzle material 316 stainless steel
- Stainless steel button activator

## Plumbing

- In built water pressure regulator ½' inlet
- 40mm Waste outlet pipe

## Finishes

- Primed and 2 pak epoxy wet spray finish
- Hot dipped galvanised prior to coating
- Available in many different colours. [See colour selector](#)
- All fountains come with vandal resistant 316 stainless steel security screws

## Fixings

- Surface mounted with Dyna bolts or in ground fixings with foundation cage
- All bolts internal

## Options

- Tap, water bottle filler, dog bowl attachment all available
- Full parts and technical back up service available
- Service kits available for purchase

[Click to view the latest Apollo 600 projects online](#)

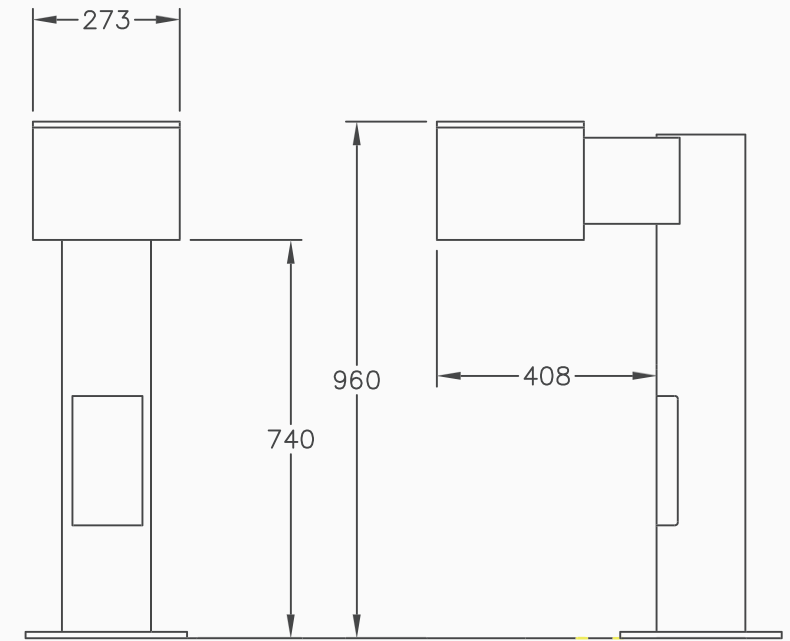

Get the latest specification news on



[www.urbanff.com.au](http://www.urbanff.com.au)

07 3382 7372

[info@urbanff.com.au](mailto:info@urbanff.com.au)

*Urban*  
fountains + furniture

# Drinking Fountain: Apollo 800

The Apollo 800 is a durable, vandal resistant Stainless Steel outdoor disabled accessible fountain. It is just one of our fountains in the Apollo range designed for disabled access.

## Dimensions

- Total Height: 940mm
- Clearance Height: 870mm
- 316 Stainless Steel main body

## Water Receptacle

- Unique mesh "no splash" catchment tray.
- Chrome nozzle
- Stainless Steel lever and handle.

## Plumbing

- In built water pressure regulator ½' inlet
- 40mm Waste outlet pipe

## Finishes

- Primed and 2 pak epoxy wet spray finish.
- Available in many different colours. Please see colour selector.
- All fountains come with vandal resistant 316 stainless steel security screws.

## Fixings

- Surface mounted with Dyna bolts or in ground fixings with foundation cage.
- All bolts internal

## Options

- Optional tap available
- Full parts and technical back up service available.
- Service kits available for purchase.
- Button activated
- Optional handle
- Dog Bowl

[Click to view the latest Apollo 800 projects online](#)

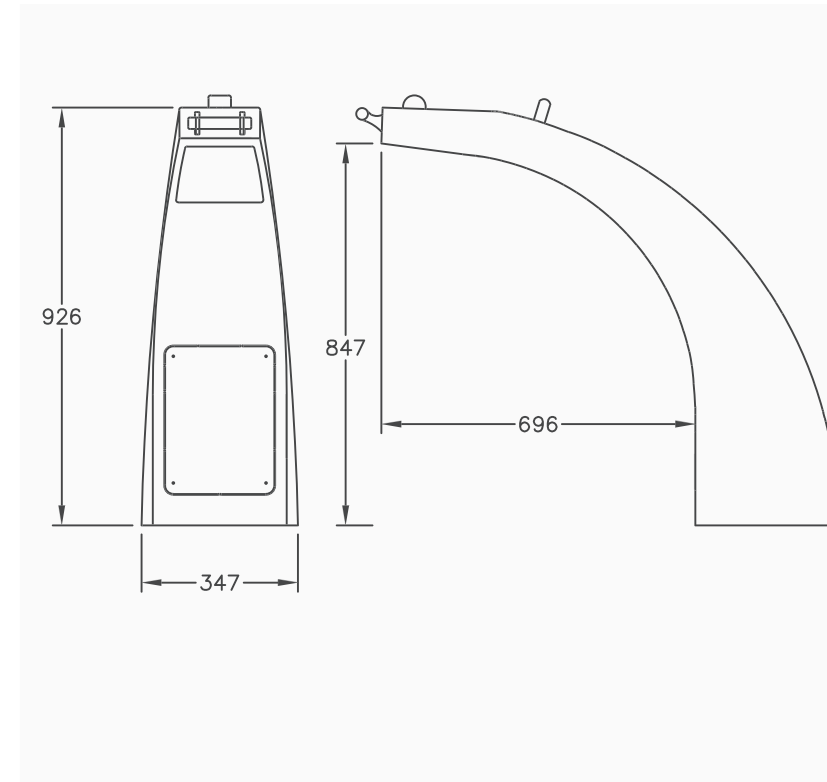

Get the latest specification news on



[www.urbanff.com.au](http://www.urbanff.com.au)

07 3382 7372

[info@urbanff.com.au](mailto:info@urbanff.com.au)

*Urban*  
fountains + furniture

# Drinking Fountain: Apollo 880

The sleek new Apollo 880 stainless steel fountain features a uniquely curved angled body like no other design in the current market. Like all Urban's outdoor disabled accessible fountains, it is durable and vandal resistant. The Apollo 880 is the "big sister" to the Apollo 800, and follows on from that popular design. It retains many of the practical functionalities of that model with just a newer, more dynamic body design.

## Dimensions

- Total Height: 915mm
- Clearance Height: 846mm
- Base: 300mm x 200mm Tapered to top

## Water Receptacle

- One piece heavy duty construction
- Easy access grab rail

## Plumbing

- 316 Stainless steel basin
- Nozzle material 316 stainless steel
- Stainless steel easy action activator lever

## Finishes

- In built water pressure regulator ½' inlet
- 40mm Waste outlet pipe

## Fixings

- Stainless steel finish
- Primed and 2 pak epoxy wet spray finish
- Powder coated. Available in many different colours. Please see colour selector.
- Anti graffiti

## Options

- Surface mounted with Dyna bolts or in ground fixings with foundation cage.
- All bolts internal
- All fountains come with vandal resistant 316 stainless steel security screws
- Optional tap &/or dog bowl available
- Full parts and technical back up service available.
- Service kits available for purchase.

[Click to view the latest Apollo 880 projects online](#)

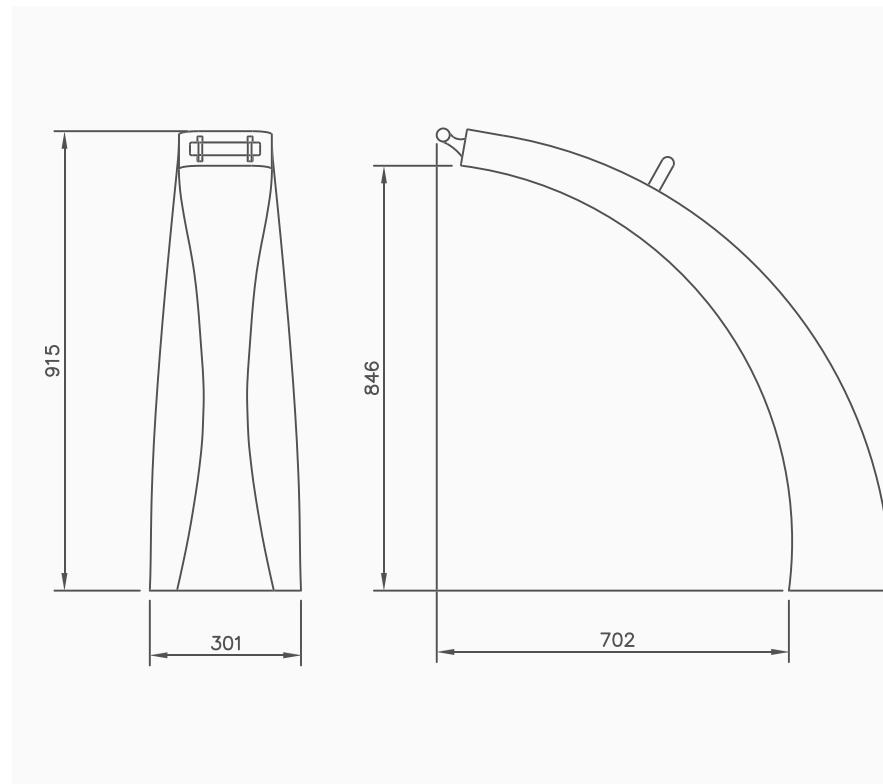

Get the latest specification news on



[www.urbanff.com.au](http://www.urbanff.com.au)

07 3382 7372

[info@urbanff.com.au](mailto:info@urbanff.com.au)

*Urban*  
fountains + furniture

# Drinking Fountain: Apollo 900

The Apollo 900 is a new, sleekly formed stainless steel fountain with a uniquely tapered body and integrated basin. It is durable and vandal resistant like all our outdoor disabled accessible fountains. This “big brother” to the Apollo 300 keeps many of its practical functionalities with an updated body design.

- Dimensions**
- Total Height: 860mm
  - Clearance Height: 760mm
  - 200mm x 100mm tapered stainless steel
  - One piece heavy duty construction
- Plumbing**
- In built water pressure regulator ½' inlet
  - 40mm Waste outlet pipe
- Finishes**
- Primed and 2 pak epoxy wet spray finish.
  - Bead blasted / electropolished, clear coated for protection, stainless steel finish
  - Available in many different colours. [See colour selector](#)
  - All fountains come with vandal resistant 316 stainless steel security screws
- Options**
- Optional tap available
  - Full parts and technical back up service available.
  - Service kits available for purchase.
  - Dog Bowl

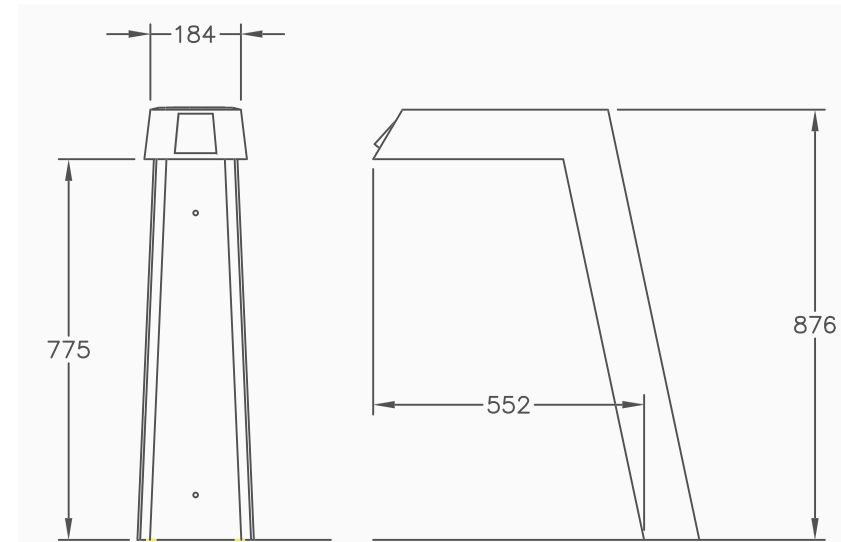

[Click to view the latest Apollo 900 projects online](#)



Get the latest specification news on



[www.urbanff.com.au](http://www.urbanff.com.au)

07 3382 7372

[info@urbanff.com.au](mailto:info@urbanff.com.au)

*Urban*  
fountains + furniture



# Drinking Fountain: PB150

The PB150 is an elegant but simple post bubbler with a unique directional external outlet flow that can be used to water surrounding garden beds. It is not suitable for disabled access.

- Dimensions**
- Total Height: 1000mm
  - 160mm x 138mm

- Water Receptacle**
- 316 stainless steel catchment tray
  - Chrome bubbler
  - Chrome self returning tap

- Finishes**
- 316 Satin stainless steel
  - Powdercoated as an option

- Fixings**
- Surface mounted with Dyna bolts or in ground fixings with foundation cage
  - 316 Stainless steel security screws on access door

- Options**
- Optional tap available
  - Optional different height
  - Full parts and technical back up service available
  - Service kits available for purchase

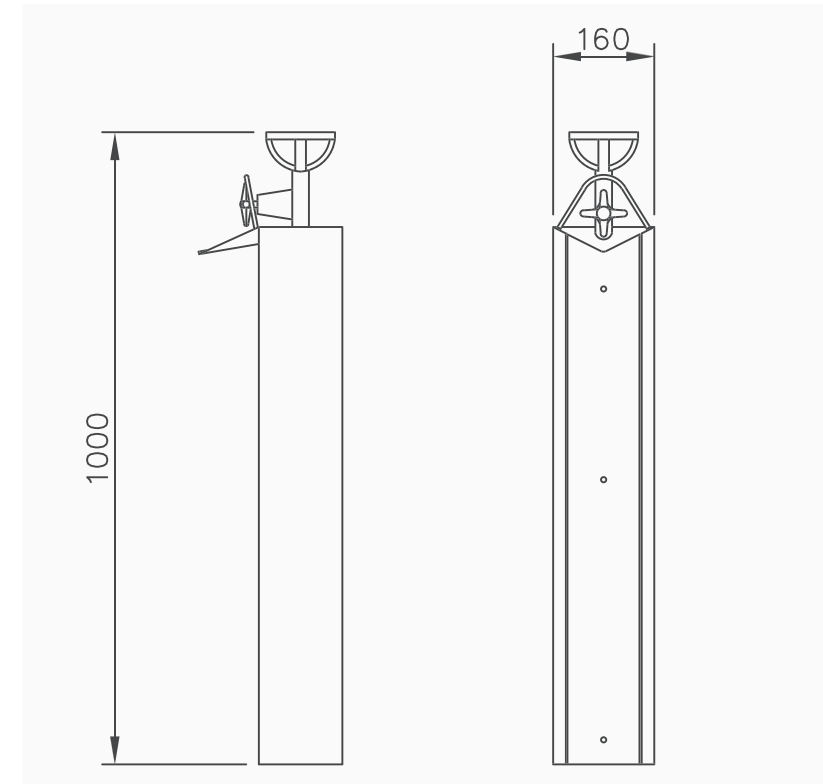

[Click to view the latest PB150 projects online](#)



Get the latest specification news on



[www.urbanff.com.au](http://www.urbanff.com.au)

07 3382 7372

[info@urbanff.com.au](mailto:info@urbanff.com.au)

*Urban*  
fountains + furniture

# Pet // Drinking Fountain: PF400

The PF 400 is a strong and robust standard upright fountain for parks, schools and any outdoor environment. It is not suitable for disabled access.

- Dimensions**
- Height: 1011mm
  - Width: 100mm
  - Dog bowl height: 173mm

- Materials**
- Steel RHS main body
  - 316 S/S dog bowl
  - Chrome activator button
  - Chrome bubbler and tap

- Finishes**
- Hot spray galvanised

- Options**
- Powdercoated as an option
  - Stainless steel
  - Dog leash handles
  - Additional tap
  - Anti vandal tap shrouds

[Click to view the latest PF400 projects online](#)

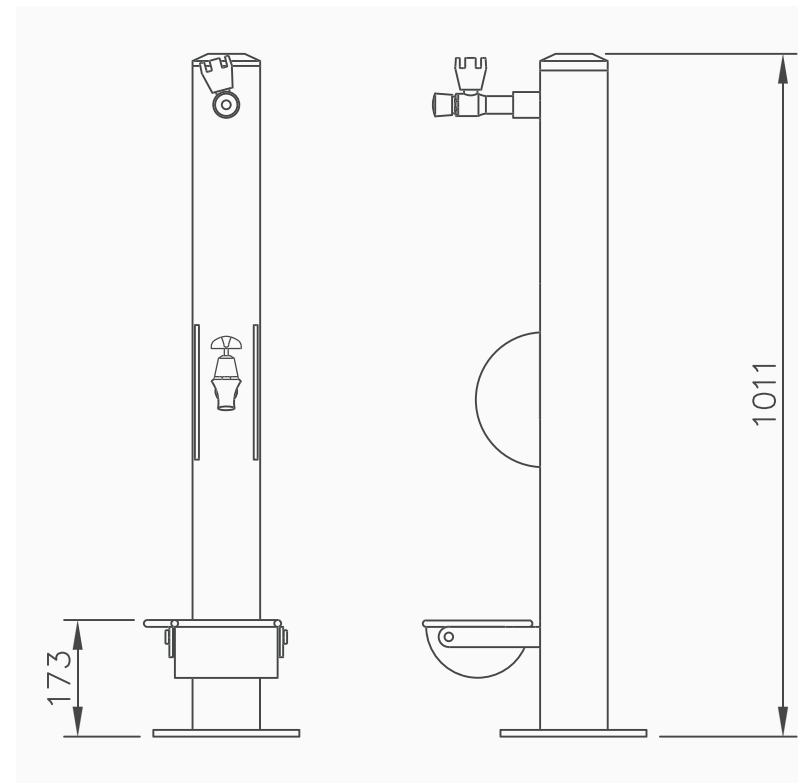

Get the latest specification news on



[www.urbanff.com.au](http://www.urbanff.com.au)

07 3382 7372

[info@urbanff.com.au](mailto:info@urbanff.com.au)

*Urban*  
fountains + furniture

# Pet // Drinking Fountain: PF600

Our pet accessible fountain enables dog lovers to provide fresh drinking water for their dogs whilst out in public places. The PF 600 is becoming increasingly popular with local councils for use in their off leash areas in parks providing water for owners and their dogs.

The common “post bubblers” with tap attachments, usually with a plastic bowl placed by a considerate dog owner, is unsightly and will soon be a thing of the past with the introduction of the PF 600. Excess water is directed in to the dog bowl which can be emptied by a simple tipping of the bowl.

- Dimensions**
- Total height: 987mm
  - Width: 257mm
  - Dog bowl height: 150mm

- Finishes**
- Hot spray galvanised
  - Powdercoated

- Options**
- Optional tap available
  - Stainless steel

[Click to view the latest PF600 projects online](#)

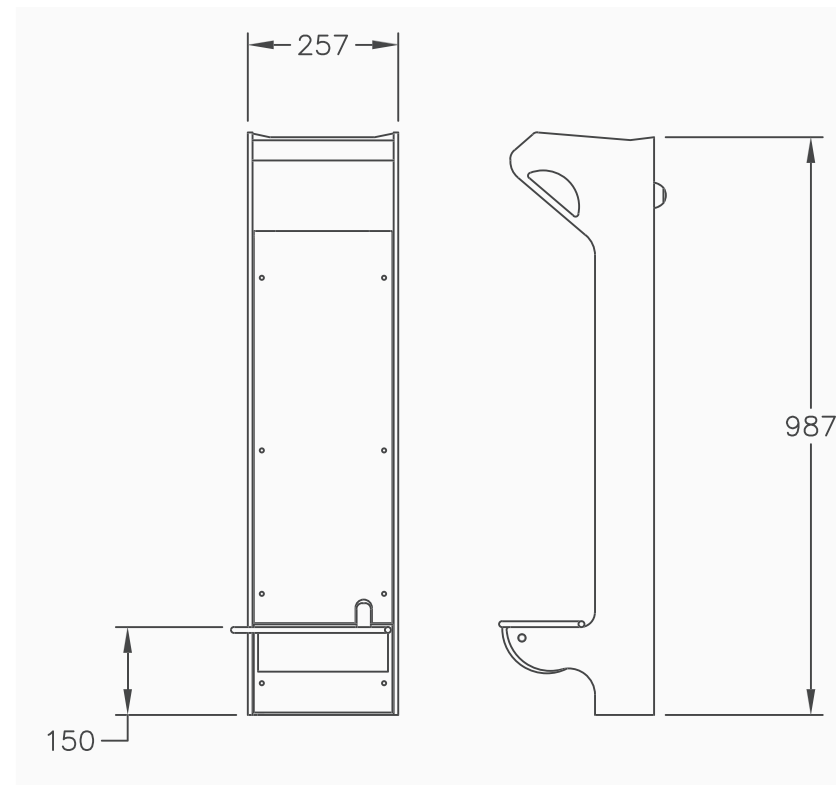

Get the latest specification news on



[www.urbanff.com.au](http://www.urbanff.com.au)

07 3382 7372

info@urbanff.com.au

*Urban*  
fountains + furniture

# Drinking Fountain: SU600

The SU 600 is a strong and robust standard upright fountain for parks, schools and any outdoor environment. It is not suitable for disabled access.

- Dimensions**
- Total Height: 1000mm
  - Diameter: 275mm
  - 5mm steel body
- Finishes**
- Hot dipped galvanised prior to coating
  - Primed and 2 pak epoxy wet spray finish
  - Available in many different colours. [See colour selector](#)
  - All fountains come with vandal resistant 316 stainless steel security screws.
- Plumbing**
- In built water pressure regulator ½' inlet
  - 40mm Waste outlet pipe
- Options**
- Optional tap available
  - Optional handle
  - Full parts and technical back up service available.
  - Service kits available for purchase.
  - Dog Bowl

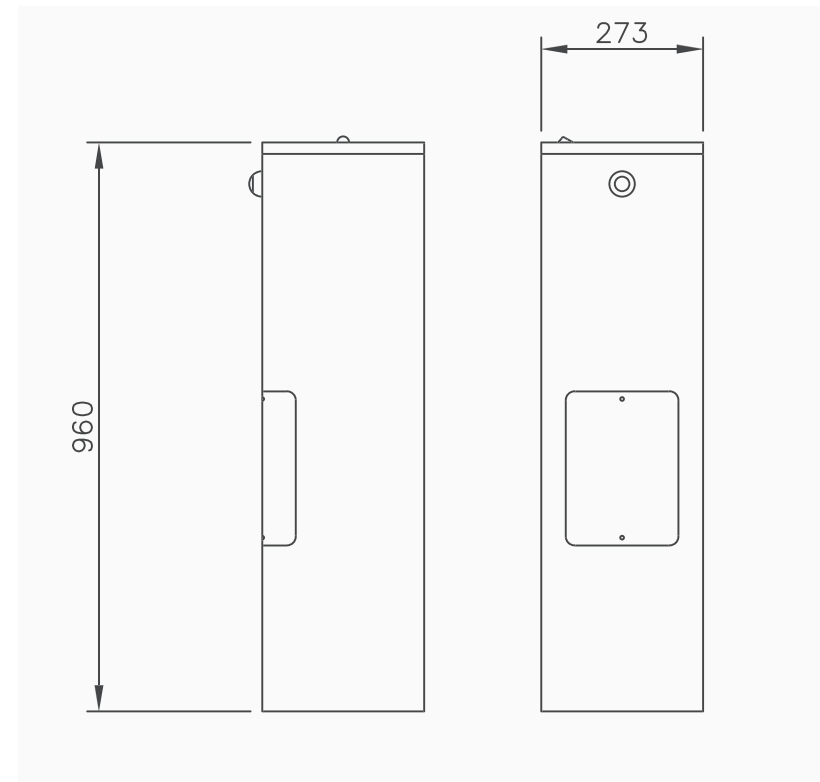

[Click to view the latest SU600 projects online](#)



Get the latest specification news on



[www.urbanff.com.au](http://www.urbanff.com.au)

07 3382 7372

[info@urbanff.com.au](mailto:info@urbanff.com.au)

*Urban*  
fountains + furniture

# Drinking Fountain: TW001

The TW001 is an upright decorative heritage style fountain to suit many park or urban settings. It is not suitable for disabled access.

- Dimensions**
- Total Height: 1010mm
  - Aluminium casting
- Finishes**
- Primed and 2 pak epoxy wet spray finish.
  - Available in many different colours. Please see colour selector.
  - All fountains come with vandal resistant 316 stainless steel security screws.
- Plumbing**
- In built water pressure regulator ½' inlet
  - 40mm waste outlet pipe
- Options**
- Optional tap available
  - Full parts and technical back up service available.
  - Service kits available for purchase.

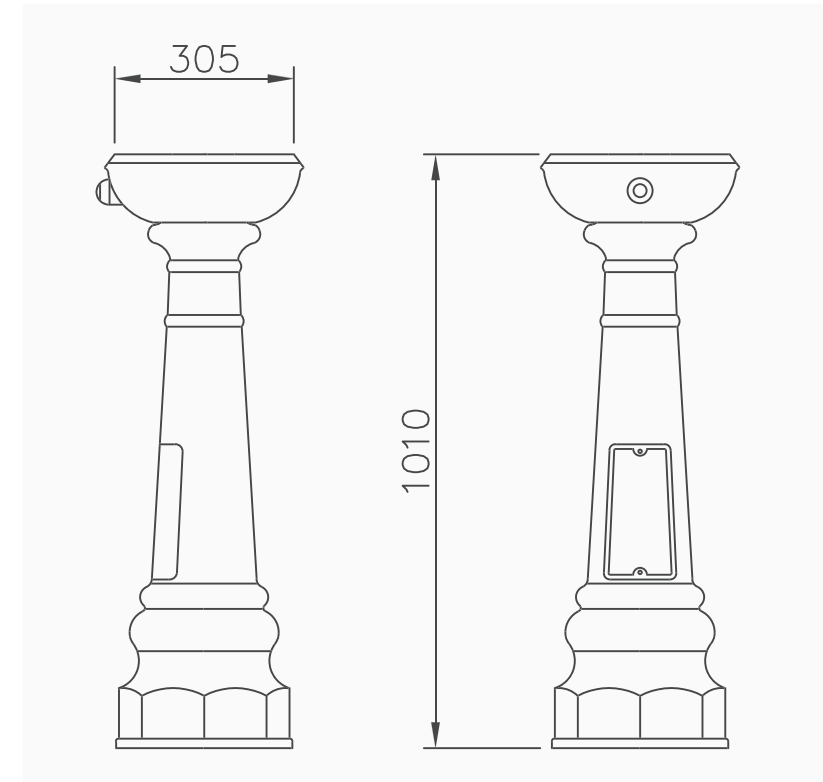

[Click to view the latest TW001 projects online](#)

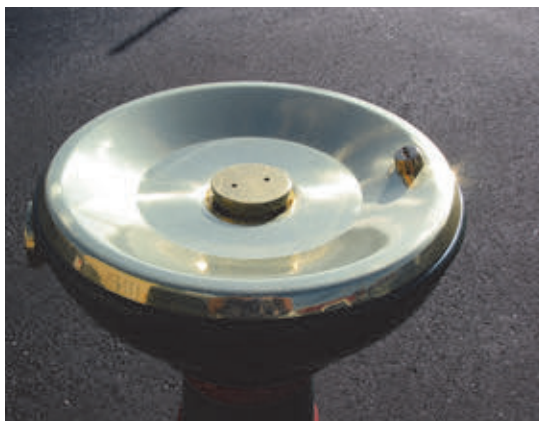

Get the latest specification news on



[www.urbanff.com.au](http://www.urbanff.com.au)

07 3382 7372

[info@urbanff.com.au](mailto:info@urbanff.com.au)

*Urban*  
fountains + furniture

# Drinking Fountain: TW002

The TW002 is a twin bowl upright decorative heritage style fountain to suit many park or urban settings. It is suitable for disabled access.

- Dimensions**
- Total Height: 1010mm
  - Disabled bowl height: 846mm
  - Aluminium casting
- Finishes**
- Primed and 2 pak epoxy wet spray finish.
  - Available in many different colours. Please see colour selector.
  - All fountains come with vandal resistant 316 stainless steel security screws.
- Plumbing**
- In built water pressure regulator ½" inlet
  - 40mm waste outlet pipe
- Options**
- Optional tap available
  - Can be modified for single bowl disabled access only
  - Full parts and technical back up service available
  - Service kits available for purchase

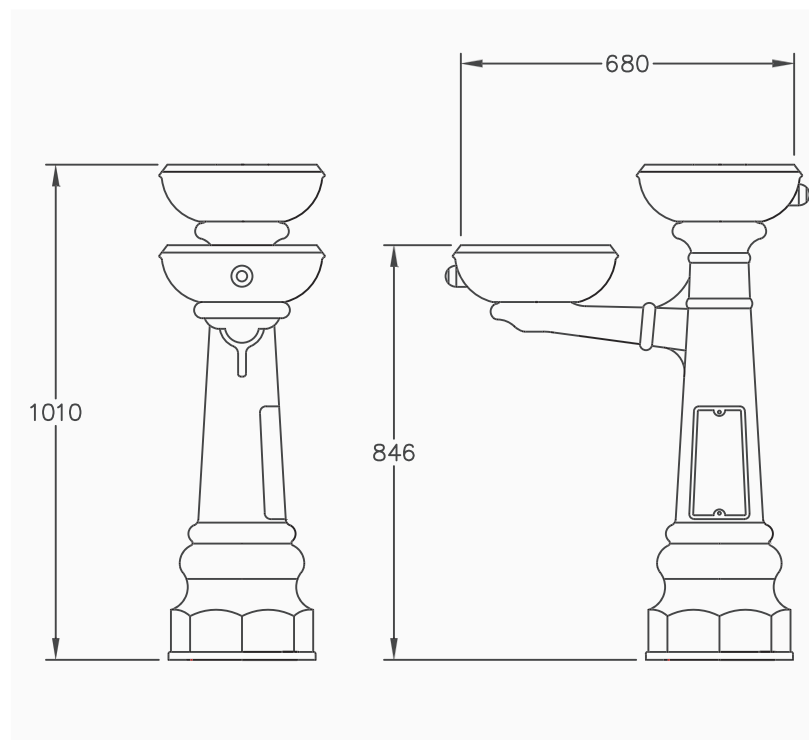

[Click to view the latest TW002 projects online](#)



Get the latest specification news on



[www.urbanff.com.au](http://www.urbanff.com.au)

07 3382 7372

info@urbanff.com.au

*Urban*  
fountains + furniture



# Products // Bench Seats



# Bench Seat: Alperton

The Alperton Bench Seat is a durable, streamlined and modern seat. Manufactured in cast aluminium with timber slats, the Alperton has been ergonomically designed to give a comfortable seating position.

All seats have been designed to give optimum strength and durability. The Alperton is made of the highest quality imported Kwila, suitably seasoned and treated with three coats of hardwood oil for durability and enhanced natural appearance.

- Dimensions**
- Seat height: 475mm
  - Seat length: 1750mm
- Materials**
- Cast aluminium
  - Kwila timber battens 168mm x 31mm, 68mm x 31mm
  - Perforated sheet metal as an option
- Finishes**
- Available in a variety of powder coated colours
  - Raw alloy finish available
  - All timber battens are Kwila timber, protected with 3 coats of hardwood oil.
- Options**
- Raw alloy finish
  - Perforated sheet metal instead of timber battens
  - Optional arm rests

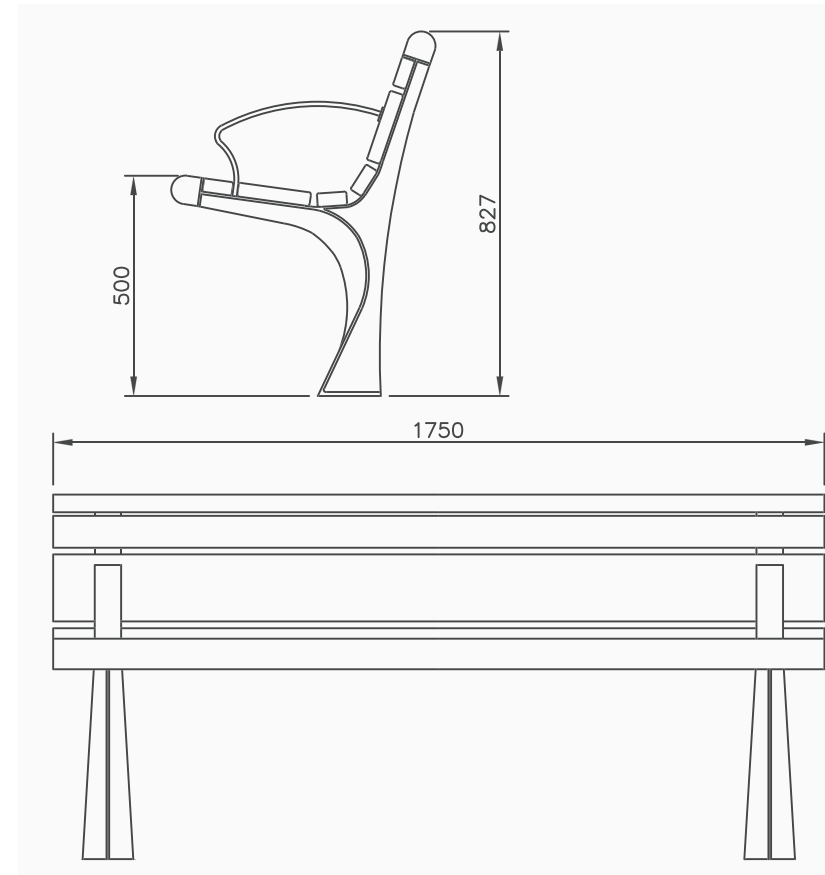

[Click to view the latest Alperton projects online](#)



Get the latest specification news on



[www.urbanff.com.au](http://www.urbanff.com.au)

07 3382 7372

[info@urbanff.com.au](mailto:info@urbanff.com.au)

*Urban*  
fountains + furniture



# Bench Seat: Aston

The Aston Bench Seat is a great example of simple, ultramodern design. Manufactured in laser cut steel with simplicity and minimalist form in mind.

All seats have been designed to give optimum strength and durability. The Aston can be tailor made to suit your individual requirements. The standard model is 1800mm long and 480mm wide but can be manufactured to any specifications. The Aston Seat is available in either steel or aluminium with the choice of timber inserts.

- Dimensions**
- Seat height: 500mm
  - Seat length: 1800mm

- Materials**
- Laser cut steel

- Finishes**
- Hot spray galvanised
  - Available in a variety of powder coated colours
  - Stainless steel

- Options**
- Timber inserts
  - Laser cut logos or motifs on seat ends
  - Variable length
  - Skateboard stoppers

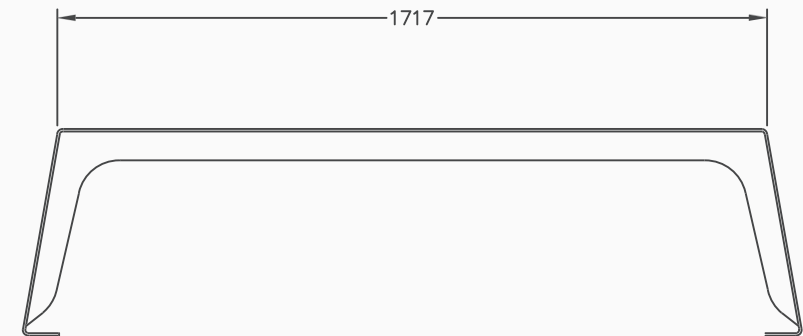
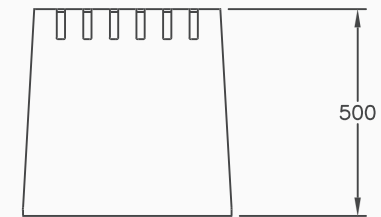

[Click to view the latest Aston projects online](#)



Get the latest specification news on



[www.urbanff.com.au](http://www.urbanff.com.au)

07 3382 7372

[info@urbanff.com.au](mailto:info@urbanff.com.au)

*Urban*  
fountains + furniture

# Bench Seat: Basic

As the name suggests, the Basic Bench Seat is a simple bench seat manufactured in steel with timber slats

All seats have been designed to give optimum strength and durability. The Basic Bench is made of the highest quality imported Kwila, suitably seasoned and treated with three coats of hardwood oil for durability and enhanced natural appearance.

- Dimensions**
- Seat height: 460mm
  - Seat length: 1750mm
- Materials**
- 50 x 50 RHS frame
  - Kwila timber battens 80mm x 20mm
  - Aluminium battens as an option
- Finishes**
- Galvanised and powdercoated
  - Available in a variety of powder coated colours
  - All timber battens are Kwila Timber protected with three coats of hardwood oil
- Options**
- Galvanised and powdercoated
  - Available in a variety of powder coated colours
  - All timber battens are double stained and clear coated with weather protection coating.

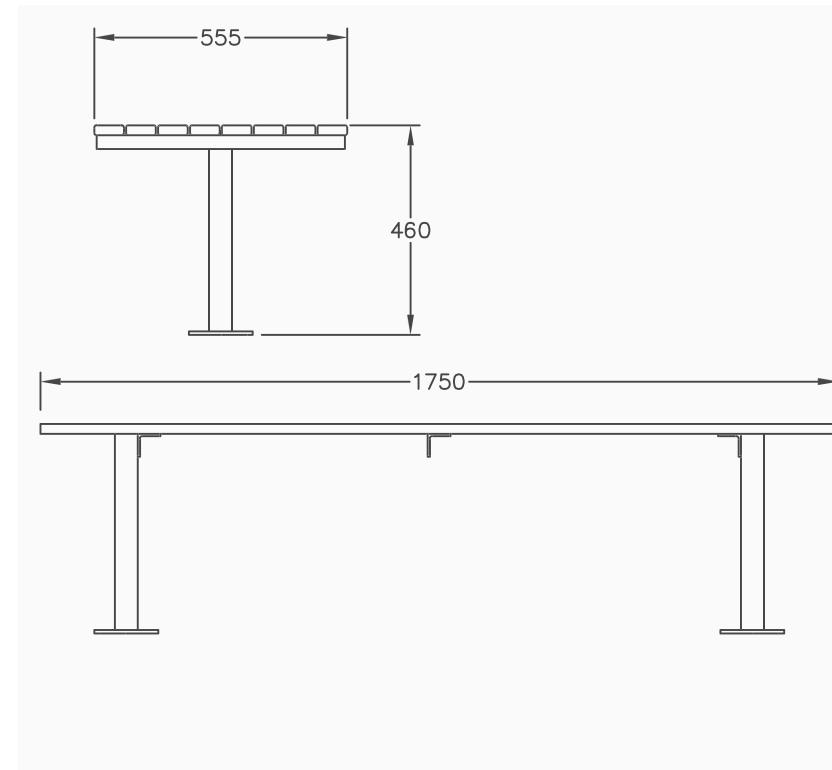

[Click to view the latest Basic projects online](#)



Get the latest specification news on



[www.urbanff.com.au](http://www.urbanff.com.au)

07 3382 7372

[info@urbanff.com.au](mailto:info@urbanff.com.au)

*Urban*  
fountains + furniture

# Bench Seat: BCC

The BCC Bench Seat is used exclusively by the Brisbane City Council throughout the CBD and suburban centres. Manufactured in cast aluminium with timber slats, the BCC Bench Seat provides a comfortable seating position.

All seats have been manufactured to give optimum strength and durability. The BCC Bench Seat is made of the highest quality imported Kwila, suitably seasoned and treated with three coats of hardwood oil for durability and enhanced natural appearance.

- Dimensions**
- Seat height: 450mm
  - Seat length: 1750mm
- Materials**
- Cast aluminium
  - Kwila timber battens 19mm x 38mm
- Finishes**
- Available in a variety of powder coated colours
  - All timber battens are Kwila timber, protected with 3 coats of hardwood oil.
- Options**
- Optional extra arm rests

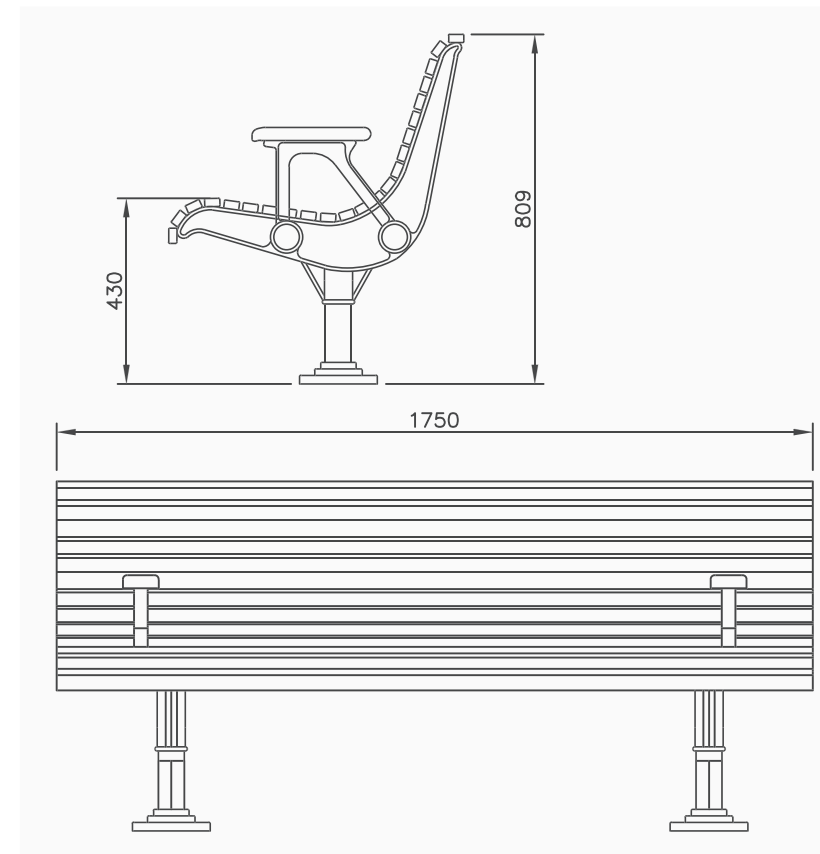

[Click to view the latest BCC projects online](#)



Get the latest specification news on



[www.urbanff.com.au](http://www.urbanff.com.au)

07 3382 7372

info@urbanff.com.au

*Urban*  
fountains + furniture

# Bench Seat: City

The City Seat is a strong and durable wall mounted seat suitable for areas within Cities and parks that may have restricted footpath access or just wanting a different look to the conventional footpath mounted seat.

- Dimensions**
- Seat height: 500mm (variable depending on mounting position)
  - Seat width: 450mm
  - Seat length: 1600mm
- Materials**
- Galvanised steel frame
  - Kwila wooden slats 42mm x 68mm
- Finishes**
- Galvanised finish
  - All timber battens are Kwila Timber, protected three coats of hardwood oil
- Options**
- Optional arm rests
  - Variable lengths available
  - Aluminium or steel battens
  - Skateboard restrictors
  - Powdercoated in your choice of colours

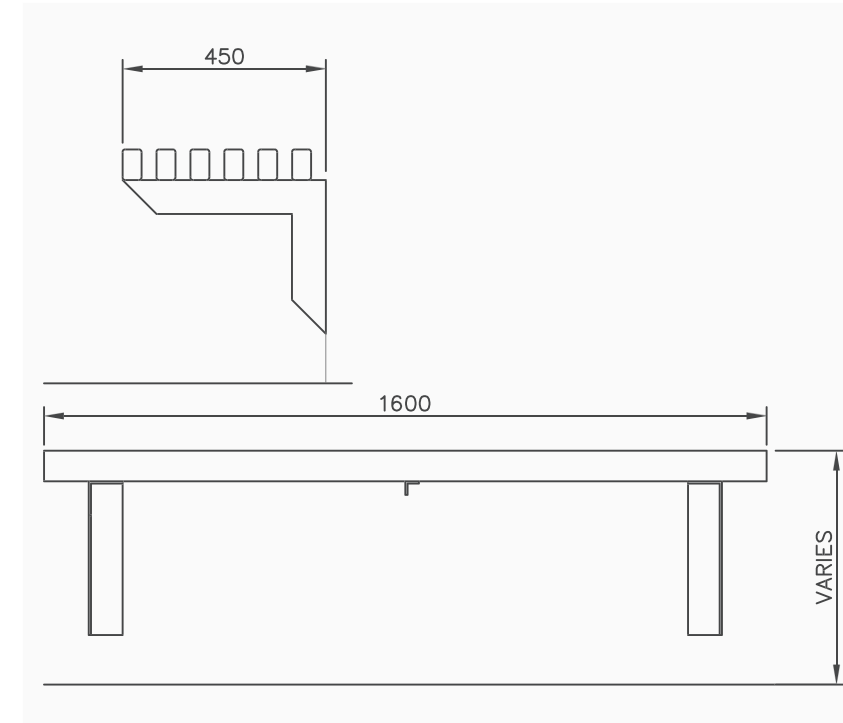

[Click to view the latest City Seat projects online](#)



Get the latest specification news on



[www.urbanff.com.au](http://www.urbanff.com.au)

07 3382 7372

[info@urbanff.com.au](mailto:info@urbanff.com.au)

*Urban*  
fountains + furniture

# Bench Seat: Euro

The Euro is a strong, durable seat with a strong modern European influence. Manufactured in tubular aluminium with timber slats, the Euro has been ergonomically designed to give a comfortable seating position.

All seats have been designed to give optimum strength and durability. The Euro is made of the highest quality imported Kwila, suitably seasoned and treated with a double stain and high quality clear coat for durability and enhanced natural appearance.

- Dimensions**
- Seat height: 455mm
  - Seat length: 1750mm
- Materials**
- 76mm Tubular aluminium
  - Kwila wooden slats 31mm x 68mm
- Finishes**
- Available in a variety of powder coated colours
  - All timber battens are Kwila timber, protected with 3 coats of hardwood oil.
- Options**
- Optional arm rests
  - Perforated sheet metal finish instead of timber
  - In ground or surface mounted
  - Wall mounting available if required

[Click to view the latest Euro projects online](#)

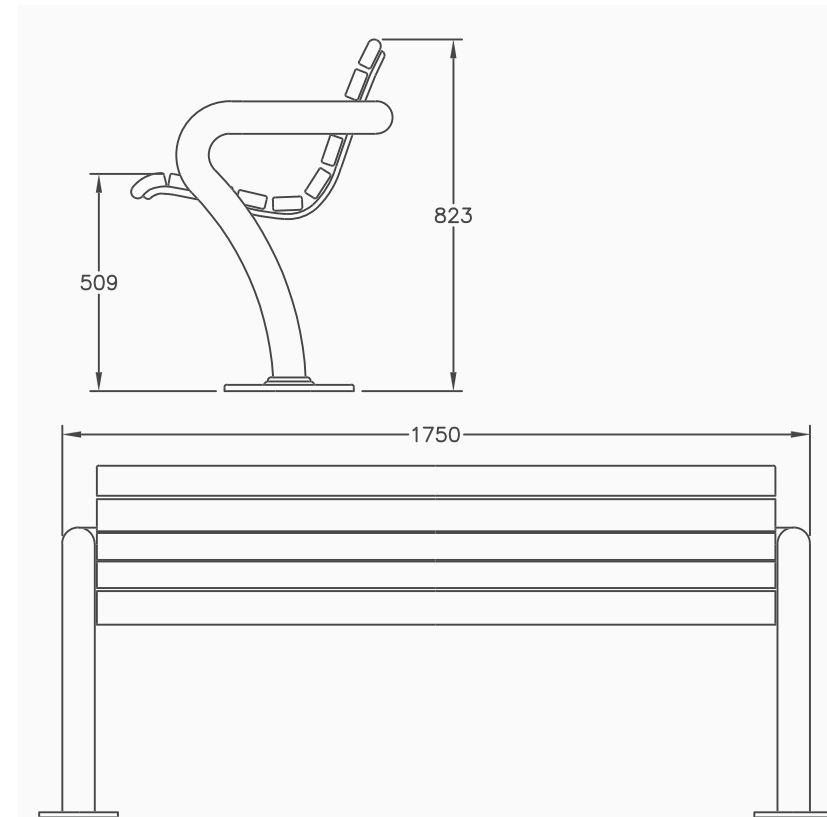

Get the latest specification news on



[www.urbanff.com.au](http://www.urbanff.com.au)

07 3382 7372

[info@urbanff.com.au](mailto:info@urbanff.com.au)

*Urban*  
fountains + furniture

# Bench Seat: Phoenix

The Phoenix is simple yet elegant seat. Manufactured in cast aluminium with timber slats, the Phoenix has been ergonomically designed to give a comfortable seating position.

All seats have been designed to give optimum strength and durability. The Phoenix is made of the highest quality imported Kwila, suitably seasoned and treated with a double stain and high quality clear coat for durability and enhanced natural appearance.

It can be tailor made to suit your individual requirements. The standard model is 1750mm long but we can manufacture to any specifications.

- Dimensions**
- Seat height: 450mm
  - Seat length: 1750mm
- Materials**
- Cast aluminium
  - Kwila wooden slats 31mm x 65mm
- Finishes**
- Powdercoated in your choice of colour
  - Kwila timber protected with 3 coats of hardwood oil
- Options**
- Arm rests

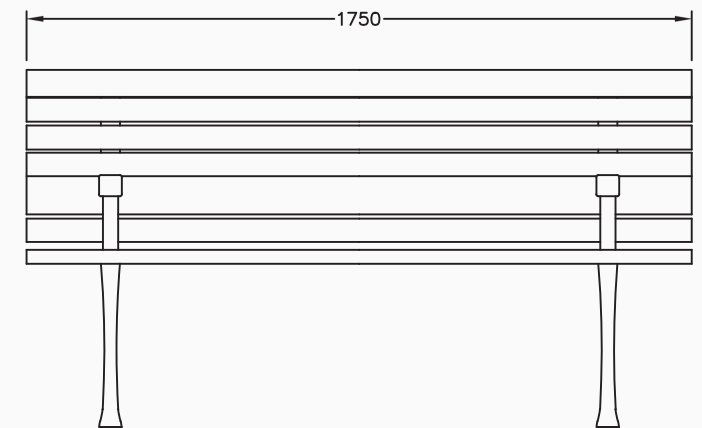
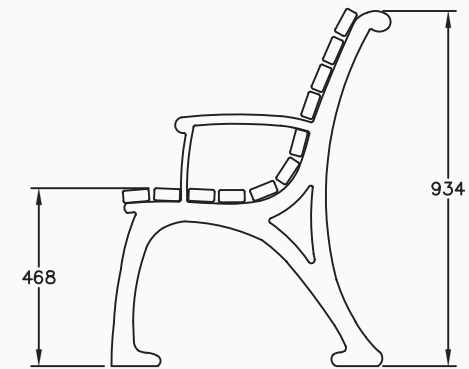

[Click to view the latest Phoenix projects online](#)



Get the latest specification news on



[www.urbanff.com.au](http://www.urbanff.com.au)

07 3382 7372

[info@urbanff.com.au](mailto:info@urbanff.com.au)

*Urban*  
fountains + furniture

# Bench Seat: SB1

The SB1 Bench Seat is a great example of simple, ultramodern design. Manufactured in laser cut steel with timber slats, the SB1 has been ergonomically designed to give a comfortable seating position.

All seats have been designed to give optimum strength and durability. The SB1 is made of the highest quality imported Kwila, suitably seasoned and treated with three coats of hardwood oil for durability and enhanced natural appearance.

- Dimensions**
- Seat height: 485mm
  - Seat length: 1703mm
- Materials**
- Laser cut steel
  - Kwila timber battens 44mm x 32mm
  - Aluminium battens as an option
- Finishes**
- Hot spray galvanised
  - Available in a variety of powder coated colours
  - All Timber Battens are Kwila Timber protected with three coats of hardwood oil
- Options**
- Aluminium battens
  - Stainless steel body

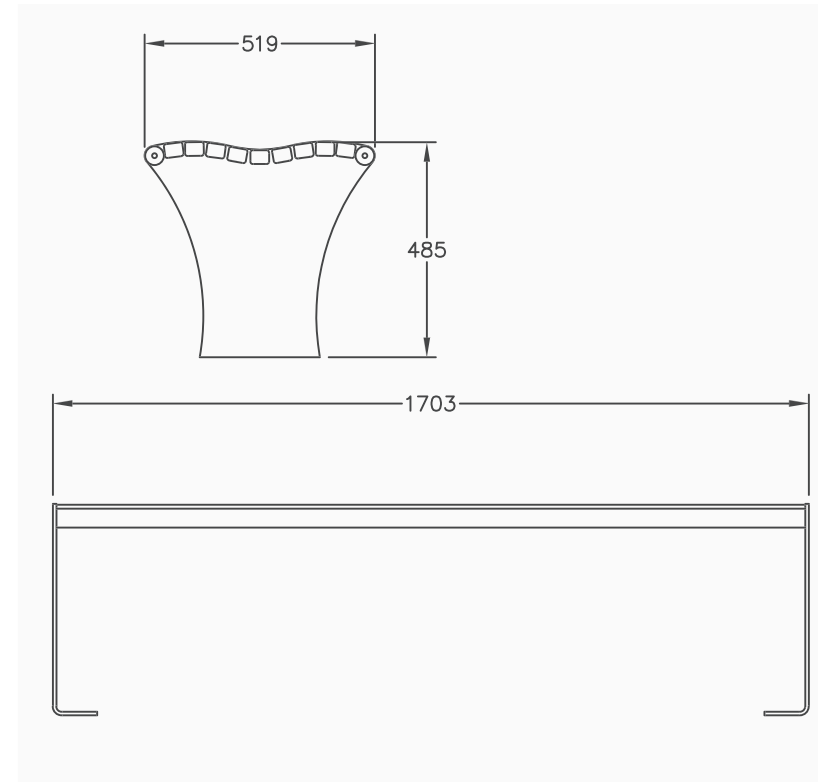

[Click to view the latest SB1 projects online](#)

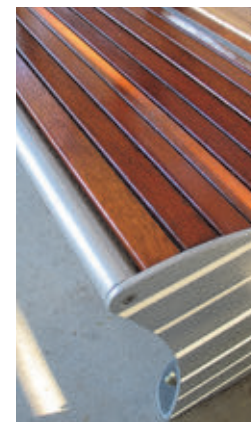

Get the latest specification news on



[www.urbanff.com.au](http://www.urbanff.com.au)

07 3382 7372

info@urbanff.com.au

*Urban*  
fountains + furniture

# Bench Seat: SB3

The SB3 Bench Seat is a great example of simple, ultramodern design. Manufactured in laser cut steel with 16mm round bars, the SB3 has been ergonomically designed to give a comfortable seating position. All seats have been designed to give optimum strength and durability.

It can be tailor made to suit your individual requirements. The standard model is 1700mm long but we can manufacture to any specifications.

## Dimensions

- Seat height: 486mm
- Seat length: 1700mm

## Materials

- Laser cut steel
- 16mm round bars

## Finishes

- Hot spray galvanised
- Available in a variety of powder coated colours
- Stainless steel

## Options

- Stainless steel rods as an option
- Laser cut logos or motifs on seat ends
- Variable length
- Skateboard stoppers

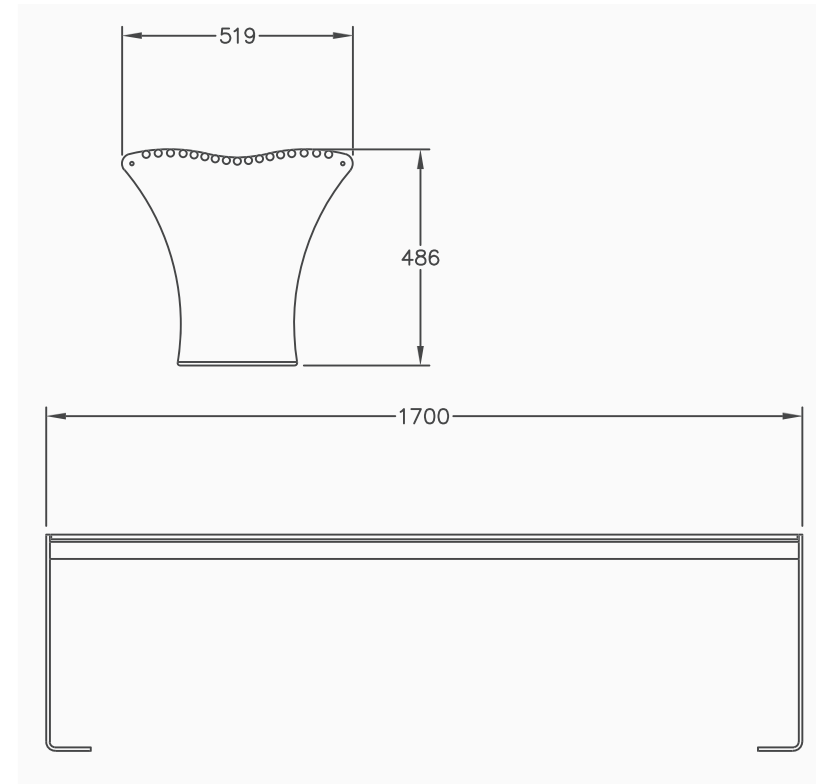

[Click to view the latest SB3 projects online](#)

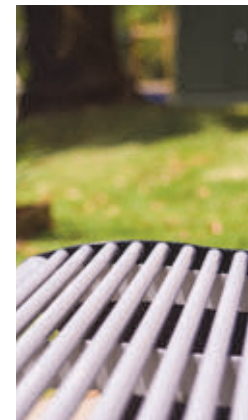

Get the latest specification news on



[www.urbanff.com.au](http://www.urbanff.com.au)

07 3382 7372

[info@urbanff.com.au](mailto:info@urbanff.com.au)

*Urban*  
fountains + furniture



# Bench Seat: SB4

The SB4 Bench Seat is a great example of simple, ultramodern design. Manufactured in laser cut steel with 16mm steel round bars and flat arm rests, the SB4 has been ergonomically designed to give a comfortable seating position.

All seats have been designed to give optimum strength and durability. The SB4 can be tailor made to suit your individual requirements. The standard model is 1800mm long but we can manufacture to any specifications.

## Dimensions

- Seat height: 503mm
- Seat length: 1800mm

## Materials

- Laser cut steel
- 16mm steel round bars
- 8mm flat bar arm rests

## Finishes

- Hot spray galvanised
- Available in a variety of powder coated colours
- Stainless steel

## Options

- Stainless steel rods as an option
- Laser cut logos or motifs on seat ends
- Variable length
- Skateboard stoppers

[Click to view the latest SB4 projects online](#)

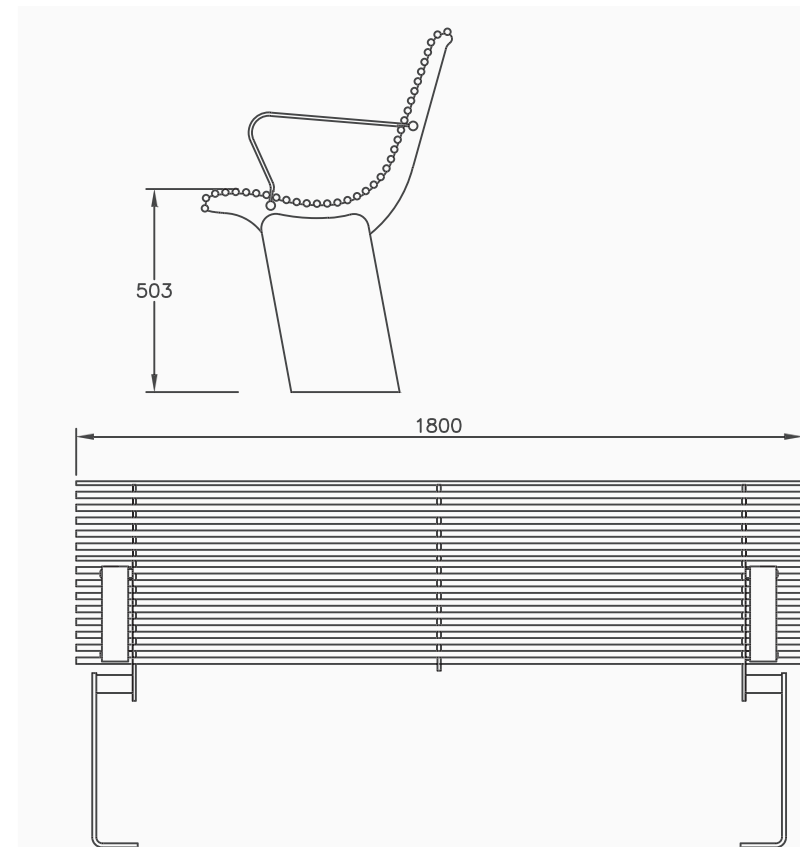

Get the latest specification news on



[www.urbanff.com.au](http://www.urbanff.com.au)

07 3382 7372

[info@urbanff.com.au](mailto:info@urbanff.com.au)

*Urban*  
fountains + furniture

# Bench Seat: SB5

Manufactured using steel plate and round bar, the seats and tables are extremely strong and able to withstand the toughest climatic and environmental conditions. They are perfect for park and Urban settings where there is high volume use.

All seats have been designed to give optimum strength and durability. The SB5 can be tailor made to suit your individual requirements. The standard model is 1750mm long but we can manufacture to any specifications.

## Dimensions

- Seat height: 486mm
- Seat length: 1750mm
- Width 533mm

## Materials

- Laser cut steel
- 16mm steel round bars

## Finishes

- Hot spray galvanised
- Available in a variety of powder coated colours
- Stainless steel

## Options

- Stainless steel rods as an option
- Laser cut logos or motifs on seat ends
- Variable length
- Skateboard stoppers
- 8mm flat bar arm rests

[Click to view the latest SB5 projects online](#)

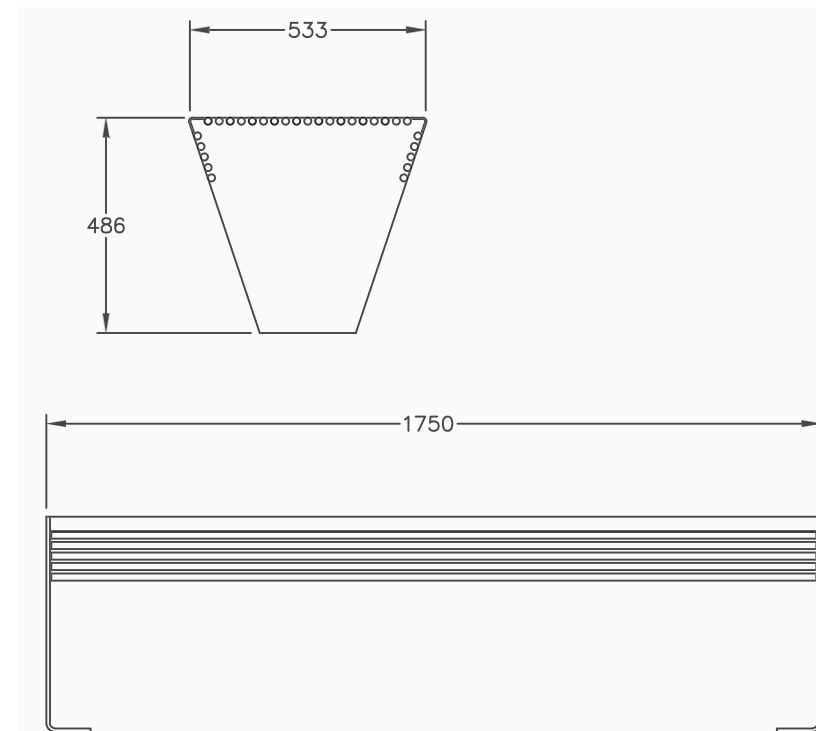

Get the latest specification news on



[www.urbanff.com.au](http://www.urbanff.com.au)

07 3382 7372

[info@urbanff.com.au](mailto:info@urbanff.com.au)

*Urban*  
fountains + furniture

# Bench Seat: Urban

The Urban Bench Seat is a great example of simple, ultramodern design. Manufactured in laser cut steel with timber slats, the Urban has been ergonomically designed to give a comfortable seating position.

All seats have been designed to give optimum strength and durability. The Urban is made of the highest quality imported Kwila, suitably seasoned and treated with three coats of hardwood oil for durability and enhanced natural appearance.

- Dimensions**
- Seat height: 475mm
  - Seat length: 1750mm

- Materials**
- Laser cut steel
  - 16mm round bars
  - Kwila timber battens 68mm x 31mm

- Finishes**
- Available in a variety of powder coated colours
  - All Timber Battens are Kwila Timber protected with three coats of hardwood oil

- Options**
- Optional arm rests
  - Stainless Steel body as an option
  - Aluminium battens as an option
  - Skateboard stoppers

[Click to view the latest Urban projects online](#)

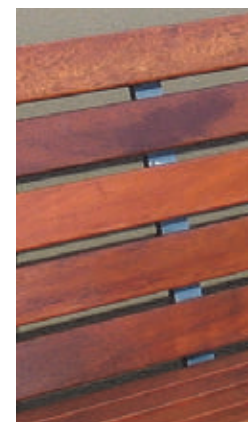
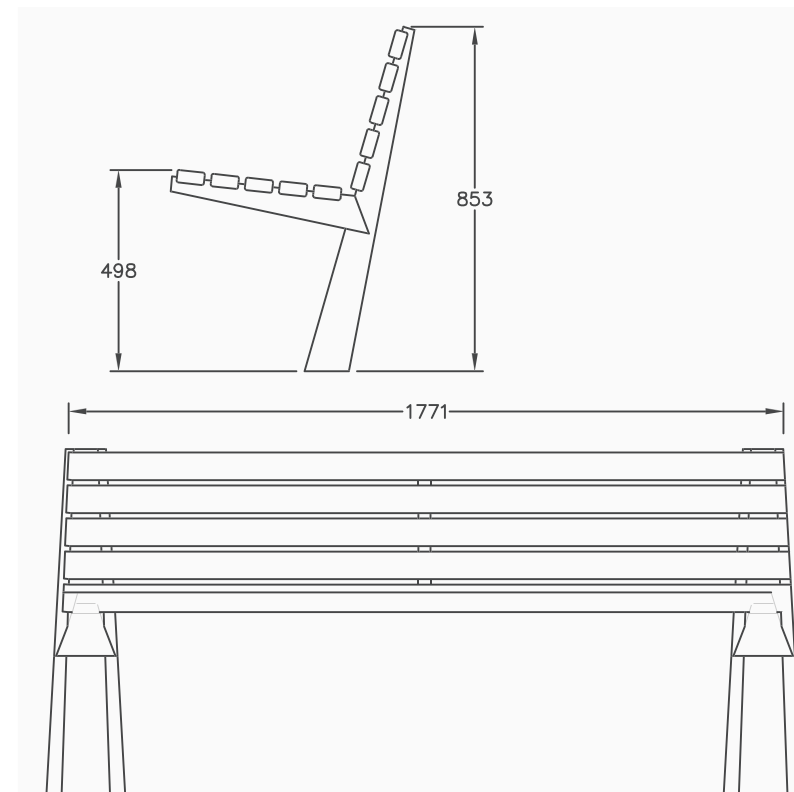

Get the latest specification news on



[www.urbanff.com.au](http://www.urbanff.com.au)

07 3382 7372

[info@urbanff.com.au](mailto:info@urbanff.com.au)

*Urban*  
fountains + furniture



## Products // Bins



# Bin: Aston

The Aston Bin is made from 8mm steel plate that is laser cut and folded. It is an extremely strong and robust bin ideal for parks and shopping centres.

- Dimensions**
- Height: 1056mm
  - Width 430mm
  - Length 575mm
  - Capacity 70 litre

- Materials**
- 8mm laser cut steel
  - 2mm stainless steel ashtray

- Finishes**
- Hot spray Galvanised
  - Powder Coated in your choice of colour
  - Kwila Timber battens are protected with three coats of hardwood oil.

- Options**
- Steel sides instead of timber
  - Aluminium battens

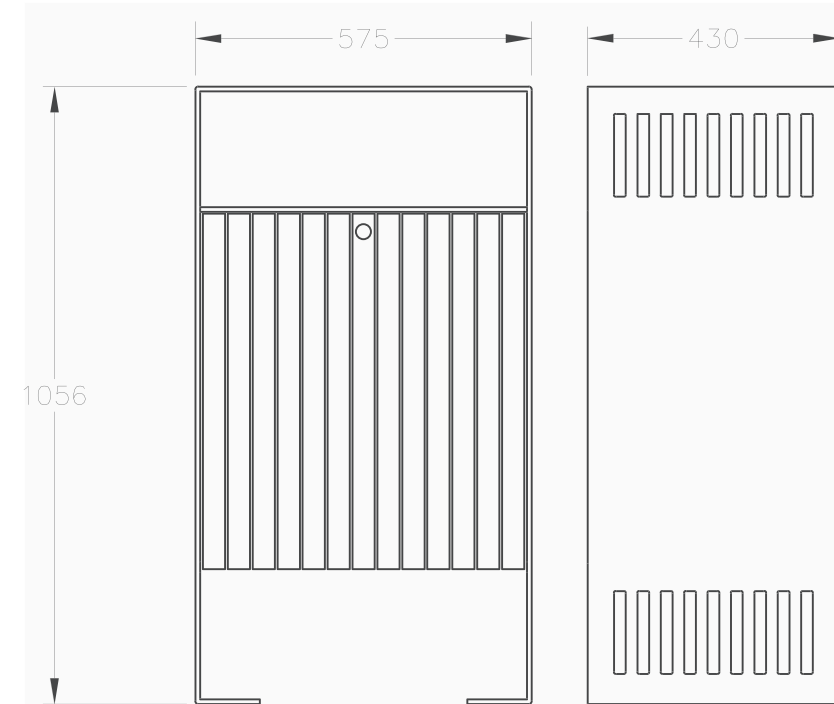

[Click to view the latest Aston projects online](#)



Get the latest specification news on



[www.urbanff.com.au](http://www.urbanff.com.au)

07 3382 7372

[info@urbanff.com.au](mailto:info@urbanff.com.au)

*Urban*  
fountains + furniture

# Butt Bin: BB01

The Cigarette Butt Bin is a uniquely designed cigarette butt receptacle that helps reduce littering by smokers.

The custom designed wide angled top allows butts to fall in to the bin by gravity reducing the unsightly collection of butts "stuck" at the top that is seen by so many other designs. The Butt Bin is emptied by a single one handed key operation.

There is no handling of the contents of the bin at all. This greatly reduces the risk of contamination by the handler and the risk of needle stick injury if inappropriate contents were put in to the bin.

- Dimensions**
- Height: 876mm
  - Receptacle Diameter 152mm
- Materials**
- Receptacle – 304 Stainless Steel
  - 50 x 50 RHS Steel Post – Zinc Plated
  - 8mm Steel Base Plate – Zinc Plated
  - Unique "Key Only" Operating System
- Finishes**
- Stainless Steel
- Fixings**
- In ground fixing available
  - Surface mounted with Dynabolts
- Options**
- Powder Coated in your choice of colour

[Click to view the latest Butt Bin projects online](#)

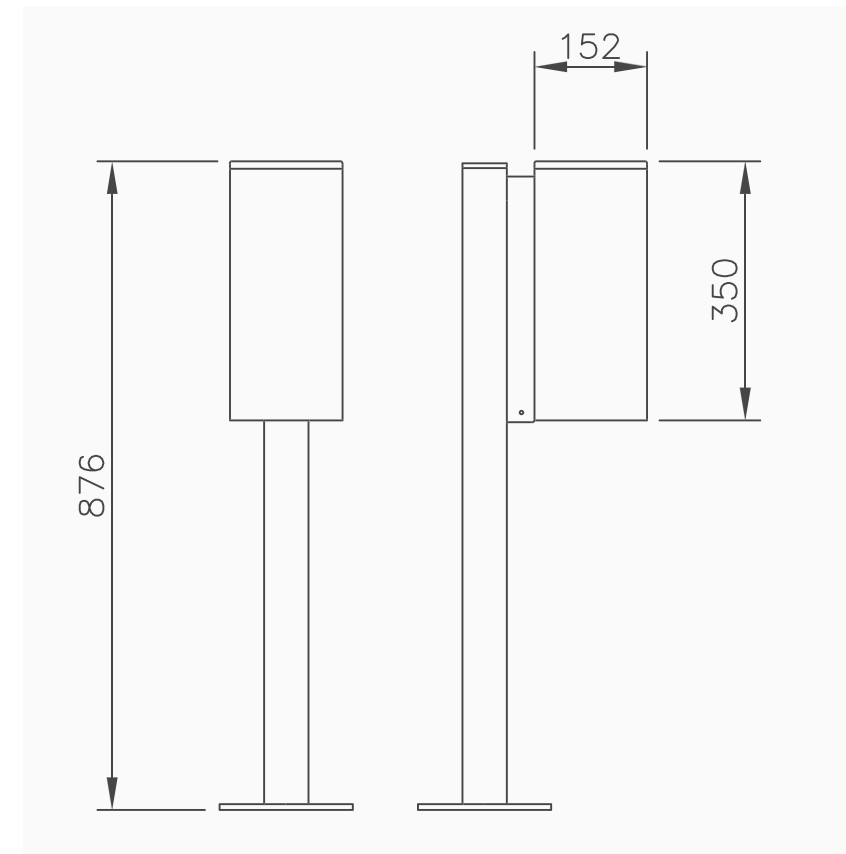

Get the latest specification news on



[www.urbanff.com.au](http://www.urbanff.com.au)

07 3382 7372

info@urbanff.com.au

*Urban*  
fountains + furniture

# Bin: BCC RB01 // RB01s

The RB01 is a strong cast aluminium bin with an optional weatherproof lid. Manufactured exclusively for the Brisbane City Council, it features the option of coming with or without its cover dome.

- Dimensions**
- Height: 820mm
  - Width 567mm
  - Capacity 70 litre
- Materials**
- Cast Aluminium
  - 2mm Stainless Steel Ashtrays
- Finishes**
- Powder coated in your choice of colour
- Options**
- Available in optional "short" version ( RB01s )
  - Additional top mounted butt receptacle

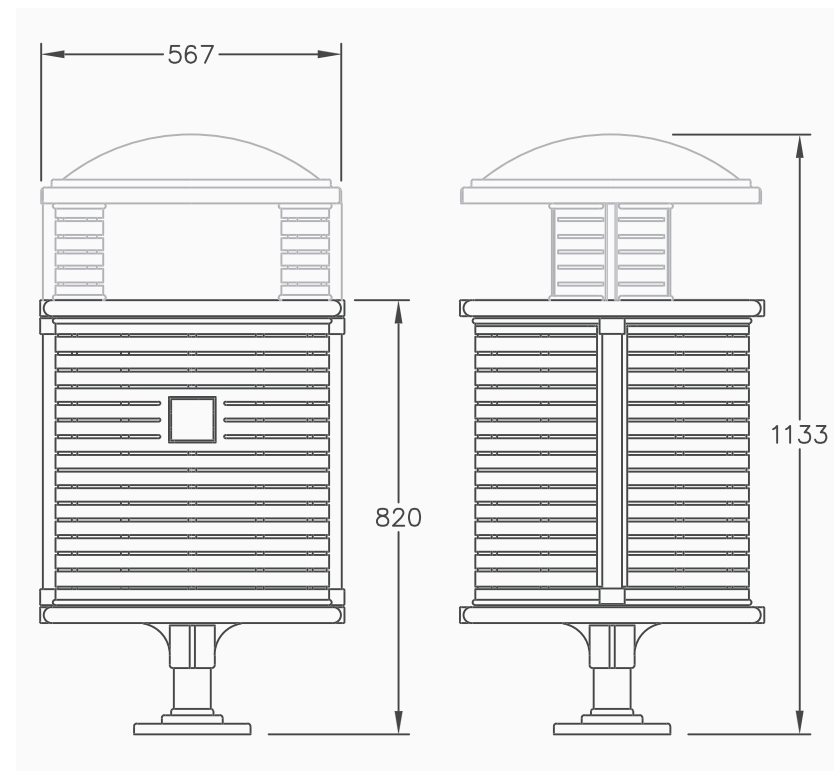

[Click to view the latest RB01 // RB01s projects online](#)



Get the latest specification news on



[www.urbanff.com.au](http://www.urbanff.com.au)

07 3382 7372

[info@urbanff.com.au](mailto:info@urbanff.com.au)

*Urban*  
fountains + furniture

# Bin: RB08 Basic

The RB08 rubbish bin is a simple, basic design yet strong and durable suitable for schools, parks and retail developments.

## Dimensions

- Height: 800mm
- Width 435mm
- Capacity 55 litre

## Materials

- 5mm steel plate
- Galvanised steel bin liner

## Finishes

- Hot dipped Galvanised
- Powder Coated in your choice of colour

## Fixings

- Surface mounted with Dyna bolts

## Options

- In ground fixing available
- Custom height available

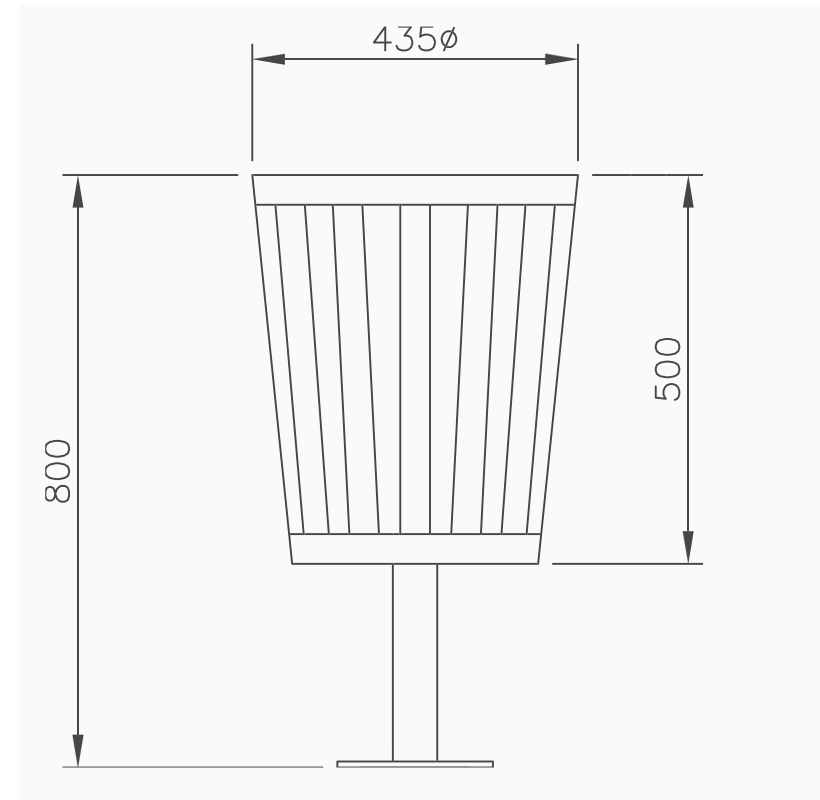

[Click to view the latest RB08 projects online](#)



Get the latest specification news on



[www.urbanff.com.au](http://www.urbanff.com.au)

07 3382 7372

[info@urbanff.com.au](mailto:info@urbanff.com.au)

*Urban*  
fountains + furniture



# Bin: RB12

The RB12 is a strong, durable short bin made from laser cut steel and cast aluminium.

- Dimensions**
- Height: 820mm
  - Width 565mm
  - Capacity 70 litre

- Materials**
- Cast aluminium and perforated steel
  - 2 Stainless steel ashtrays

- Finishes**
- Powder coated in your choice of colour

- Fixings**
- Surface mounted with Dyna bolts

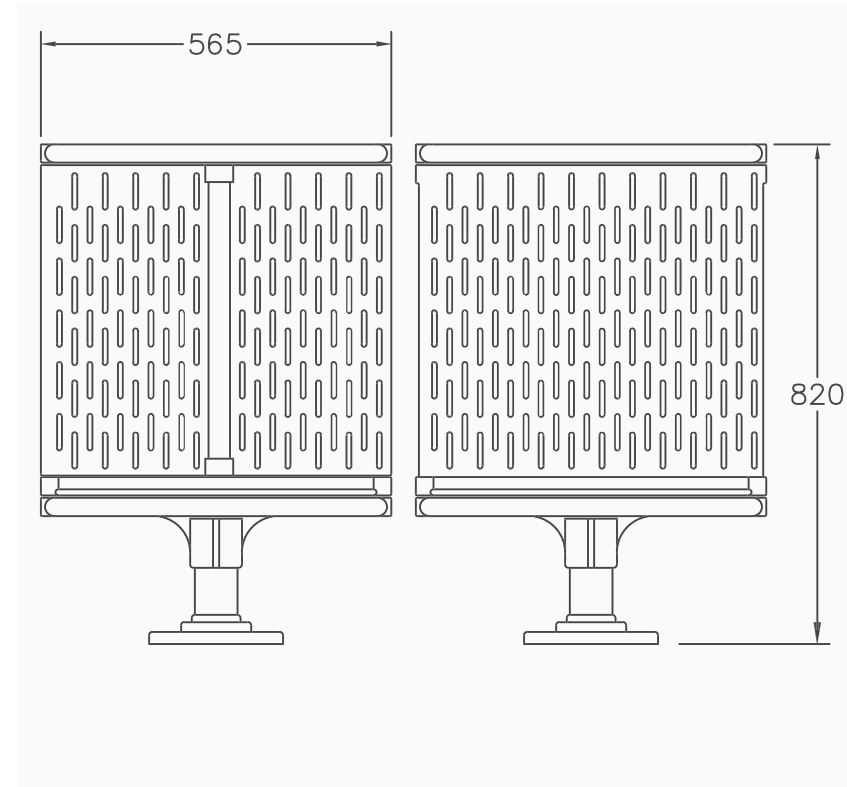

[Click to view the latest RB12 projects online](#)



Get the latest specification news on



[www.urbanff.com.au](http://www.urbanff.com.au)

07 3382 7372

[info@urbanff.com.au](mailto:info@urbanff.com.au)

*Urban*  
fountains + furniture



Products // Outdoor Showers

# Shower: Eco

The Eco Shower is a uniquely designed, triangular, curved outdoor shower. Stylish yet simplistic in design, the Eco Shower would compliment any Australian beachfront, public swimming facility or private resort.

- Dimensions**
- Height: 2207mm
  - 170 x 155 x 140mm
- Materials**
- 316 Stainless Steel
  - 8mm Base plate in 316 Stainless steel
  - Timed water activator buttons
  - Chromed shower roses
- Finishes**
- 2 Pak Epoxy wet spray finish
- Fixings**
- Surface mounted with Dyna bolts
  - Fixing cage
- Options**
- Foot shower combination
  - Optional tap
  - Hand & towel rails

[Click to view the latest Eco Shower projects online](#)

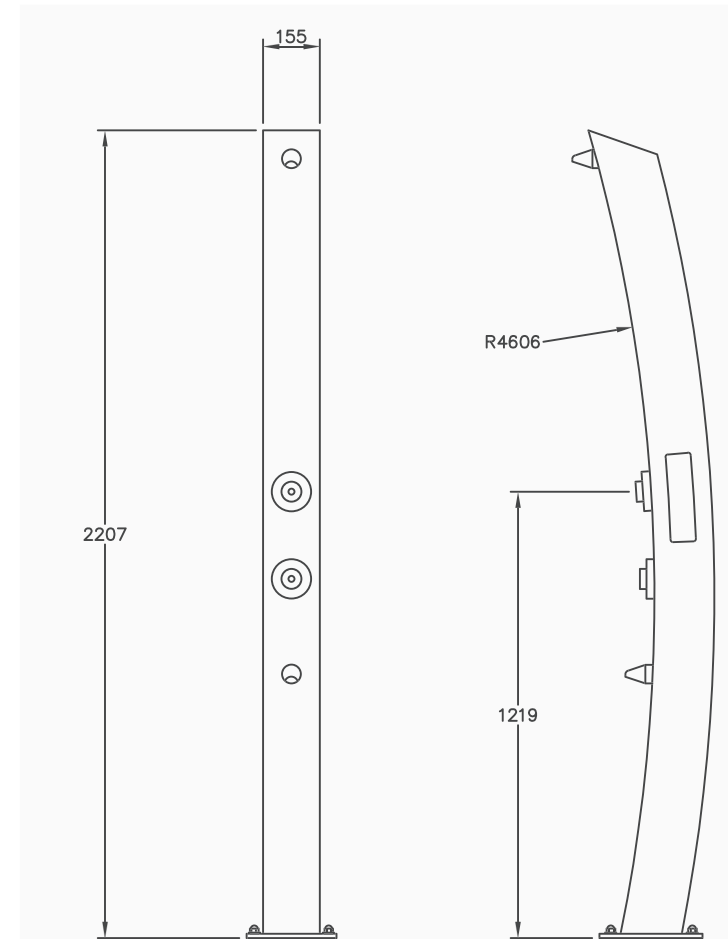

Get the latest specification news on



[www.urbanff.com.au](http://www.urbanff.com.au)

07 3382 7372

[info@urbanff.com.au](mailto:info@urbanff.com.au)

*Urban*  
fountains + furniture

# Shower: SS150

Our SS150 stainless steel showers would compliment any Australian beachfront, public swimming facility or private resort. We use only 445 and 316 stainless steel sheeting that will withstand the harshest coastal climate and prevent corrosion. The stainless steel can also be powder coated in a variety of colours to blend with or enhance the surrounding environment. All activator buttons are on set timings to prevent water wastage.

- Dimensions**
- Height: 2200mm
  - Width 162mm
- Materials**
- 445 Stainless Steel
  - 8mm Base plate in 316 Stainless steel
  - Timed water activator buttons
  - Chromed shower roses
- Finishes**
- Satin stainless finish
- Fixings**
- Electropolished
- Options**
- Surface mounted with Dyna bolts
  - In-ground
  - Wall mounted
  - Foot shower combination
  - Side mounted taps
  - Hand rails

[Click to view the latest SS150 projects online](#)

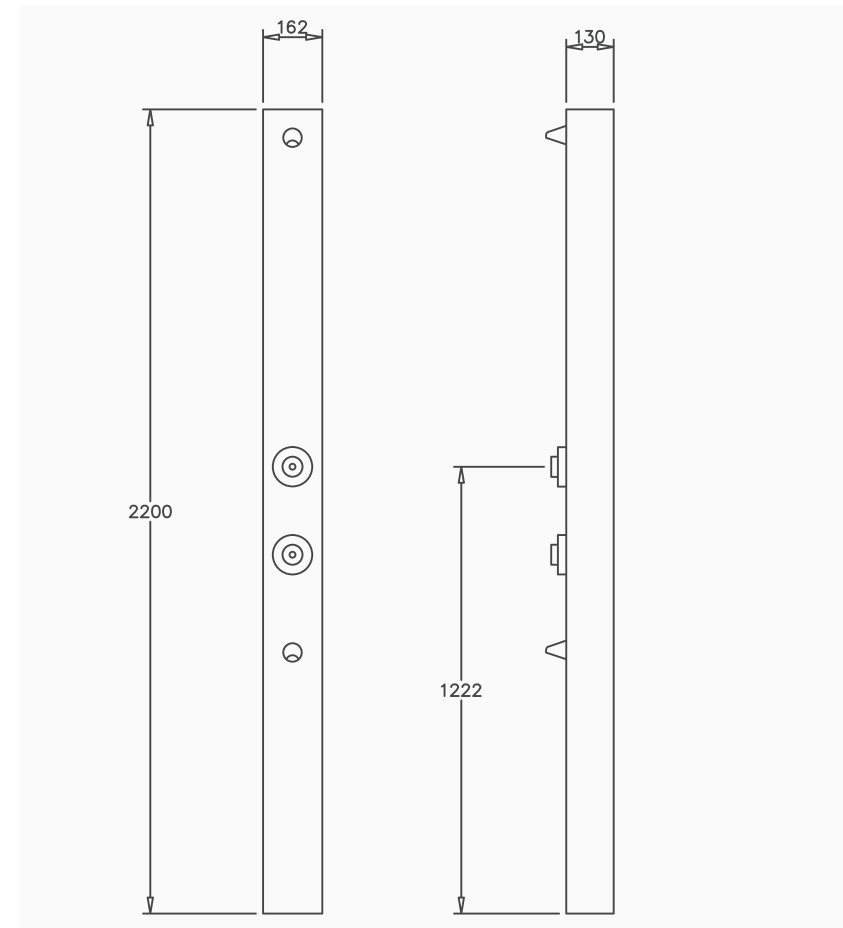

Get the latest specification news on



[www.urbanff.com.au](http://www.urbanff.com.au)

07 3382 7372

info@urbanff.com.au

*Urban*  
fountains + furniture



Products // Picnic Tables

# Picnic Table: PT02

The PT02 is a heavy duty picnic table with separate seating and recessed leg supports to accommodate wheelchair access.

- Dimensions**
- Seat Height 450mm
  - Length 2000mm
  - Table Height 800mm
  - Seats 6-8 persons
  - Wheelchair access at either end of table

- Materials**
- Aluminium support frame
  - Kwila wooden slats 31mm x 68mm

- Finishes**
- Powder coated in your choice of colour
  - Kwila timber protected with 3 coats of hardwood oil

- Fixings**
- Surface mounted with Dyna bolts

- Options**
- Aluminium battens instead of timber
  - Extra length up to 2500mm on request

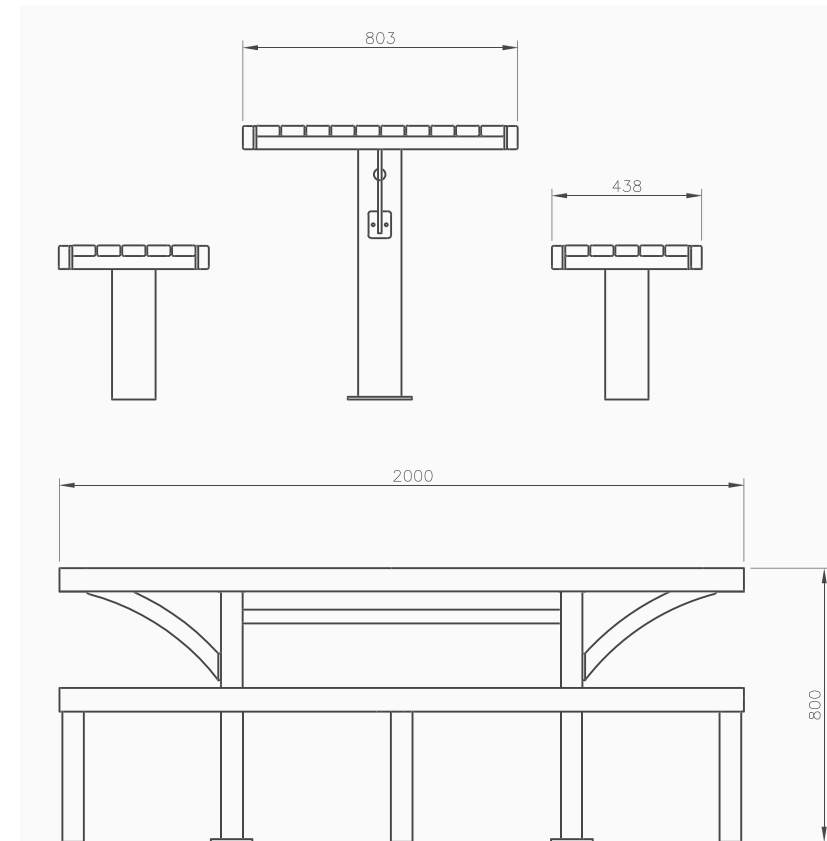

[Click to view the latest PT02 projects online](#)

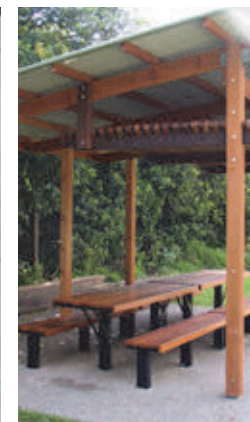

Get the latest specification news on



[www.urbanff.com.au](http://www.urbanff.com.au)

07 3382 7372

[info@urbanff.com.au](mailto:info@urbanff.com.au)

*Urban*  
fountains + furniture

# Picnic Table: PT03

The PT03 is a one piece strong & durable picnic table with seating attached to accommodate 6 people.

## Dimensions

- Seat Height: 504mm
- Length: 1750mm
- Table Height: 807mm
- Table Width: 870mm
- Total Width: 1650mm
- Seats 6 persons

## Materials

- Galvanised steel support frame
- Kwila wooden slats 140mm x 31mm

## Finishes

- Galvanised only finish
- Powder coated in your choice of colour
- Kwila timber protected with 3 coats of hardwood oil

## Fixings

- Surface mounted with Dyna bolts

## Options

- Aluminium battens instead of timber
- Extra seating on request
- Variable height and length

[Click to view the latest PT03 projects online](#)

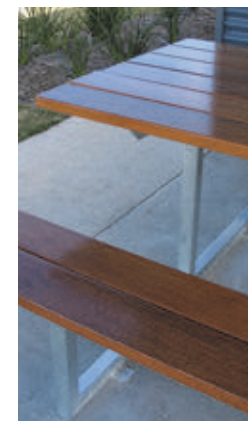
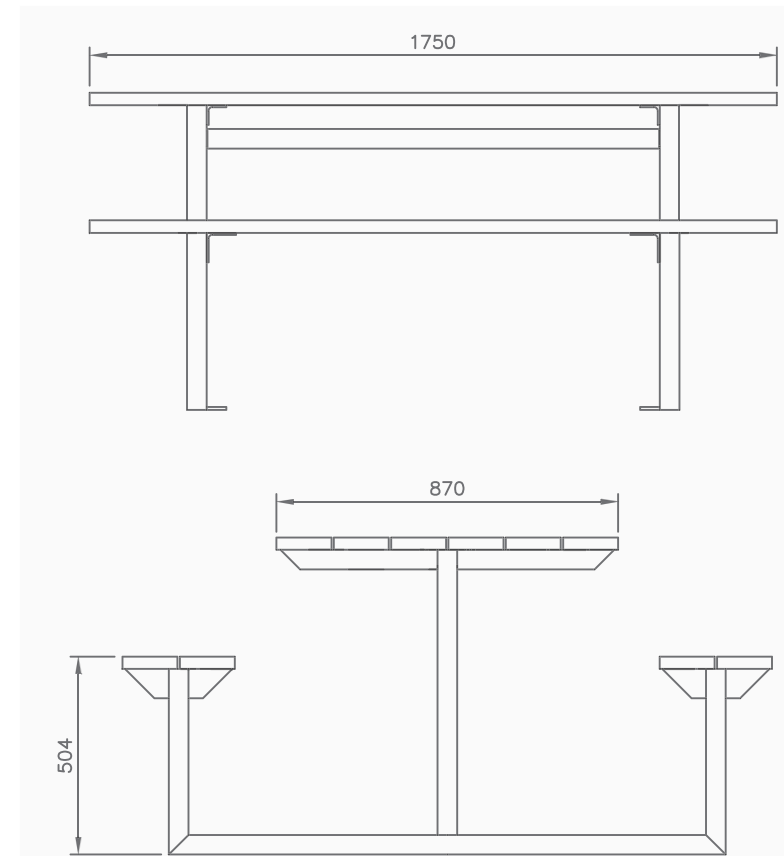

Get the latest specification news on



[www.urbanff.com.au](http://www.urbanff.com.au)

07 3382 7372

[info@urbanff.com.au](mailto:info@urbanff.com.au)

*Urban*  
fountains + furniture

# Picnic Table: PT04

The PT04 is a one piece strong & durable picnic table with seating attached to accommodate 6 people.

- Dimensions**
- Seat Height: 500mm
  - Length: 1750mm
  - Table Height: 810mm
  - Table Width: 762mm
  - Total Width: 1600mm
  - Seats 6-8 persons

- Materials**
- Galvanised steel support frame
  - Aluminium extrusion battens 250mm x 55mm

- Finishes**
- Hot dipped galvanised finish
  - Powder coated in your choice of colour

- Fixings**
- Surface mounted with Dyna bolts

- Options**
- Timber battens instead of aluminium
  - Extra seating on request
  - Variable height and length

[Click to view the latest PT04 projects online](#)

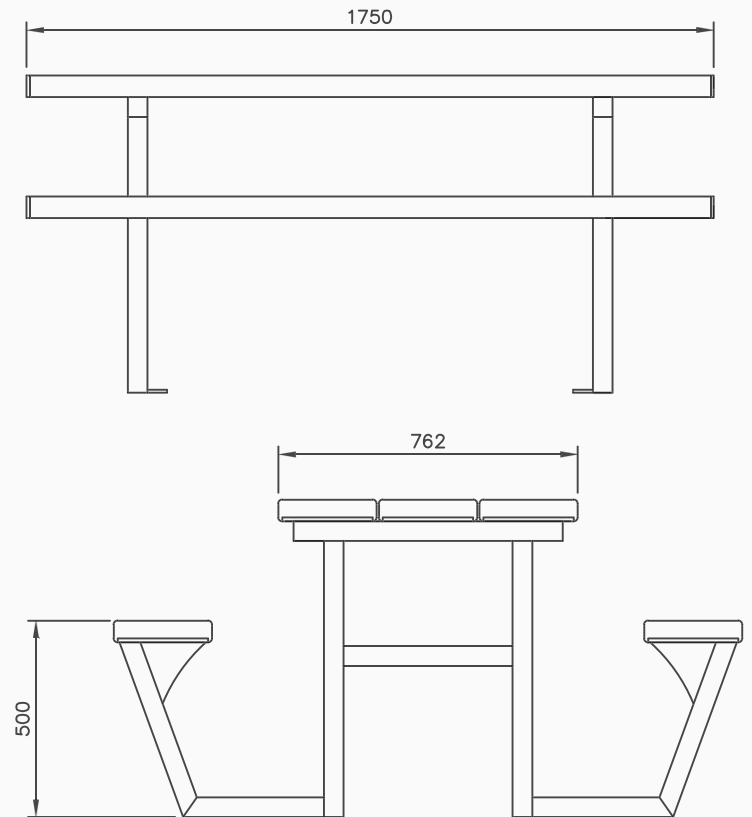

Get the latest specification news on



[www.urbanff.com.au](http://www.urbanff.com.au)

07 3382 7372

[info@urbanff.com.au](mailto:info@urbanff.com.au)

*Urban*  
fountains + furniture



# Picnic Table: PT05

The PT05 is an extremely strong and durable picnic table setting with little or no maintenance requirements. The table complements the SB3 steel rod seating.

## Dimensions

- Seat Height: 500mm
- Length: 1750mm
- Table height: 800mm
- Table width: 875mm
- Seats 6 persons

## Materials

- 8mm galvanised steel support frame
- 16mm solid round bar
- Hot spray galvanised finish
- Powder coated in your choice of colour

## Finishes

- Surface mounted with Dynabolts

## Fixings

- In ground fixing available
- Surface mounted with Dynabolts

## Options

- Variable length available
- Extra seating on request
- Stainless steel rods
- Your logo or motif laser cut into ends (example pictured)

[Click to view the latest PT05 projects online](#)

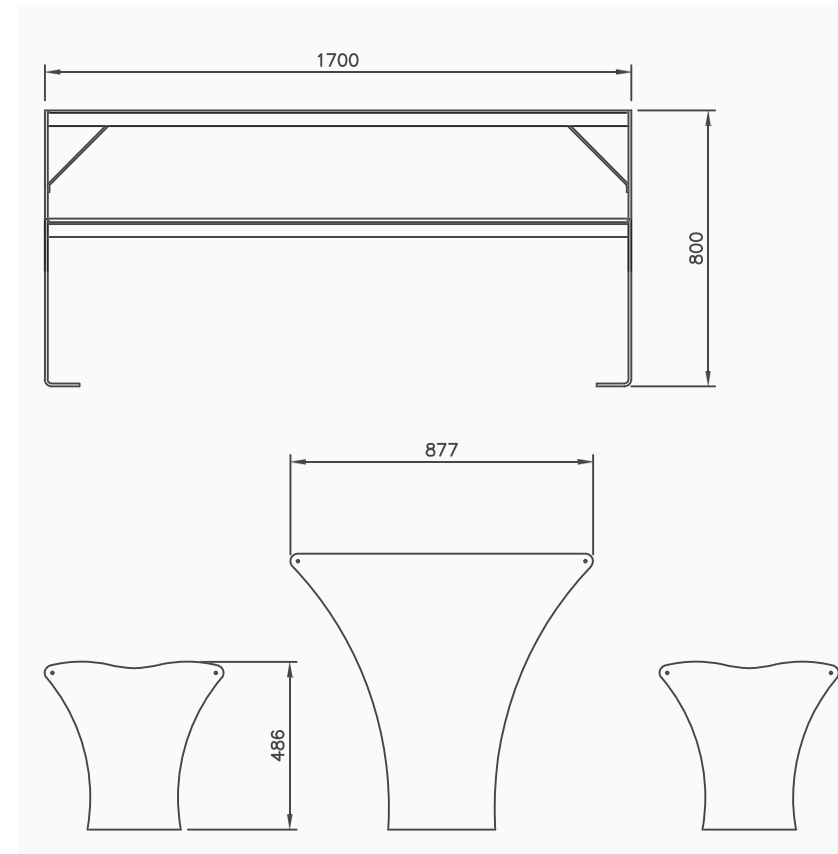

Get the latest specification news on



[www.urbanff.com.au](http://www.urbanff.com.au)

07 3382 7372

info@urbanff.com.au

*Urban*  
fountains + furniture

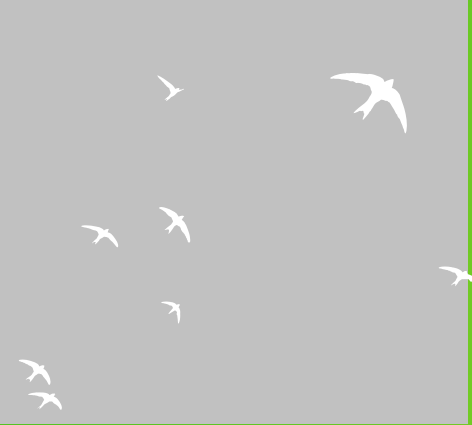

# Products // Dog Play Equipment



# Dog Play Equipment: Double Bar Dog Jump

The Dog Jump is part of Urban's extensive range of dog exercise equipment we manufacture for use in off leash areas within City Council Parks. These areas are becoming increasingly popular as Councils recognise the need to provide dog friendly areas within local parks.

All dog exercise equipment is made of galvanised steel and powder coated for extra durability. A variety of powder coated colours available. Stainless Steel could also be used if required. It can be mounted either below or above ground.

- Dimensions**
- Total height: 449mm above ground
  - First bar height: 140mm
  - Width: 1197mm
- Materials**
- 40NB Steel tubing
- Finishes**
- Galvanised
  - Powdercoated
- Fixings**
- In-ground 270mm
  - or surface mounted with base plate (extra cost incurred)
- Options**
- Variable height and width available on request
  - Stainless steel

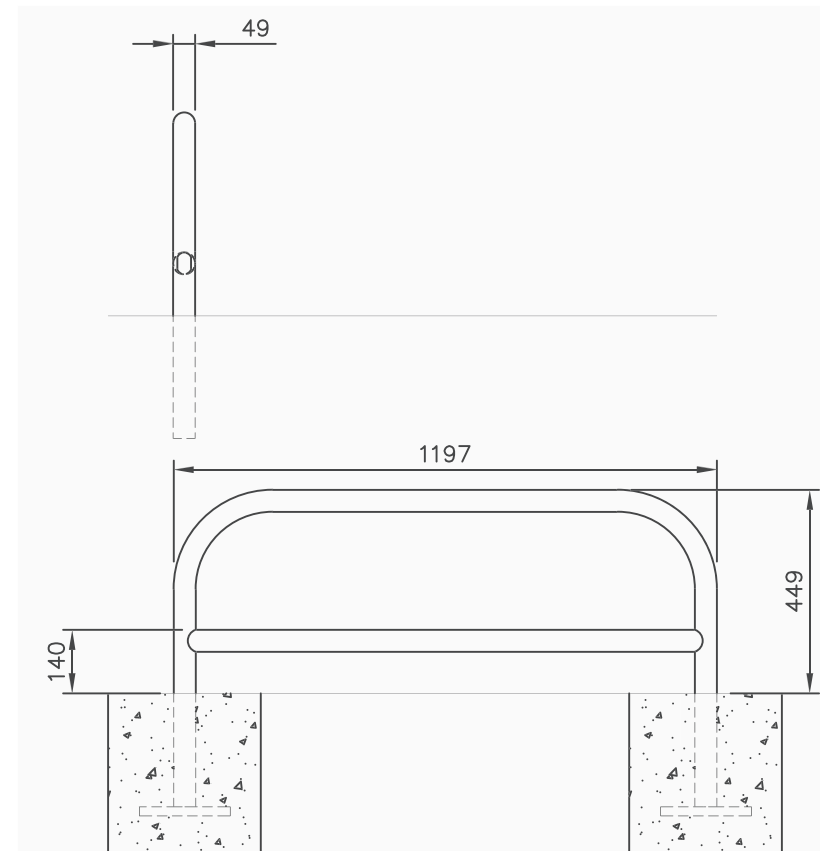

[Click to view the latest Dog Jump projects online](#)



Get the latest specification news on



[www.urbanff.com.au](http://www.urbanff.com.au)

07 3382 7372

info@urbanff.com.au

*Urban*  
fountains + furniture

# Dog Play Equipment: Dog Hoop

The Dog Hoop is part of Urban's extensive range of dog exercise equipment we manufacture for use in off leash areas within City Council Parks. These areas are becoming increasingly popular as Councils recognise the need to provide dog friendly areas within local parks.

All dog exercise equipment is made of galvanised steel and powder coated for extra durability. A variety of powder coated colours available. Stainless Steel could also be used if required. It can be mounted either below or above ground.

- Dimensions**
- Height 997mm
  - Width 795mm
  - 500mm OD Centre hole
- Materials**
- Steel frame construction
- Finishes**
- Galvanised, primed and powder coated.
- Fixings**
- In-ground
  - Surface mounted with base plate (extra cost incurred)
- Options**
- Variable height available on request

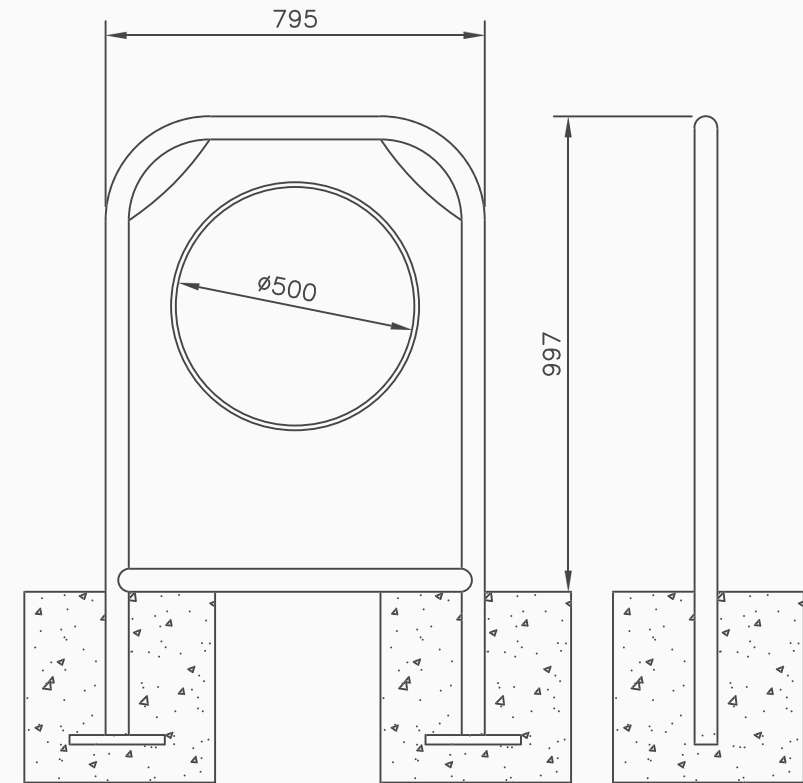

[Click to view the latest Dog Hoop projects online](#)



Get the latest specification news on



[www.urbanff.com.au](http://www.urbanff.com.au)

07 3382 7372

info@urbanff.com.au

*Urban*  
fountains + furniture

# Dog Play Equipment: Dog Podium

The Dog Podium is part of Urban's extensive range of dog exercise equipment we manufacture for use in off leash areas within City Council Parks. These areas are becoming increasingly popular as Councils recognise the need to provide dog friendly areas within local parks.

All dog exercise equipment is made of galvanised steel and powder coated for extra durability. A variety of powder coated colours available. Stainless Steel could also be used if required. It can be mounted either below or above ground.

- Dimensions**
- Height: 600mm
  - Width: 480mm
  - Length: 1600mm
- Materials**
- Steel frame construction
  - Galvanised Sheeting
- Finishes**
- Galvanised, primed and powder coated.
  - External anti slip coating
- Fixings**
- In-ground
  - Surface mounted with base plate (extra cost incurred)
- Options**
- Variable dimensions available on request

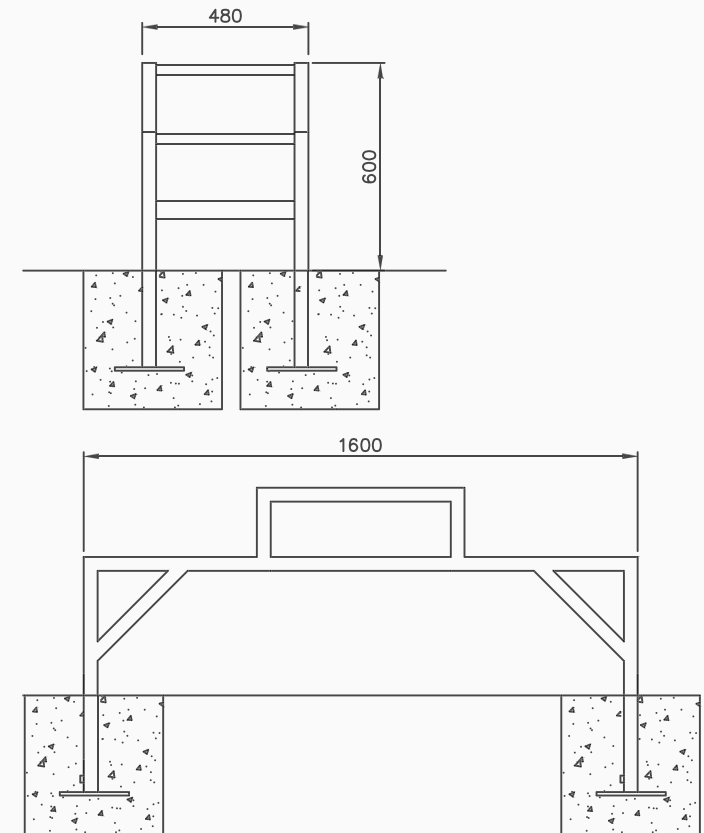

[Click to view the latest Dog Podium projects online](#)



Get the latest specification news on



[www.urbanff.com.au](http://www.urbanff.com.au)

07 3382 7372

[info@urbanff.com.au](mailto:info@urbanff.com.au)

*Urban*  
fountains + furniture

# Dog Play Equipment: Pyramid Dog Ramp

The Pyramid Ramp is part of Urban's extensive range of dog exercise equipment we manufacture for use in off leash areas within City Council Parks. These areas are becoming increasingly popular as Councils recognise the need to provide dog friendly areas within local parks.

All dog exercise equipment is made of galvanised steel and powder coated for extra durability. A variety of powder coated colours available. Stainless Steel could also be used if required. It can be mounted either below or above ground.

- Dimensions**
- Height 975mm
  - Width 495mm
  - Length 2000mm
- Materials**
- Steel RHS frame construction
  - Galvanised sheeting
- Finishes**
- Galvanised, primed and powder coated.
  - External anti slip coating
- Fixings**
- In-ground
  - Surface mounted with base plate (extra cost incurred)
- Options**
- Variable Dimensions available on request

[Click to view the latest Pyramid Ramp projects online](#)

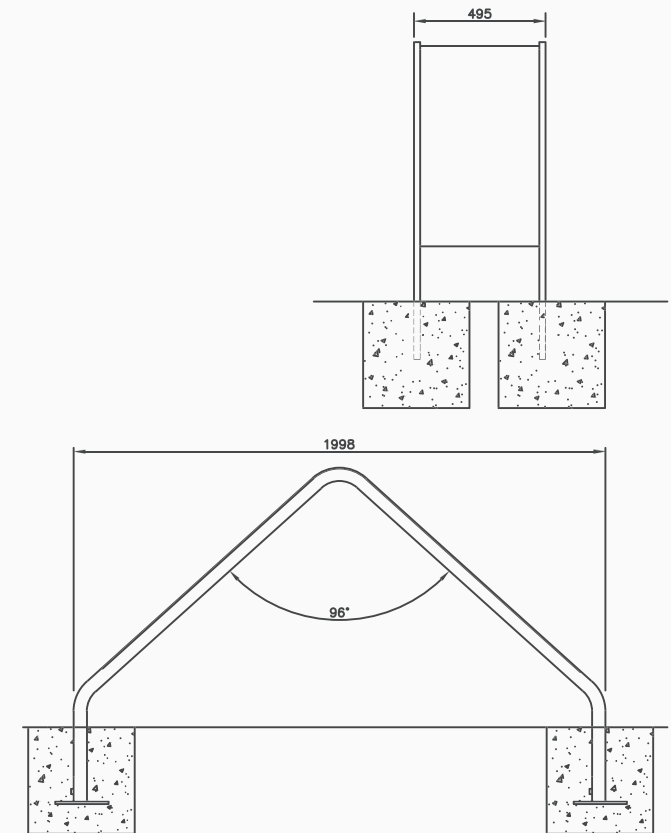

Get the latest specification news on



[www.urbanff.com.au](http://www.urbanff.com.au)

07 3382 7372

info@urbanff.com.au

*Urban*  
fountains + furniture

# Dog Play Equipment: Single Bar Dog Jump

The Dog Jump is part of Urban's extensive range of dog exercise equipment we manufacture for use in off leash areas within City Council Parks. These areas are becoming increasingly popular as Councils recognise the need to provide dog friendly areas within local parks.

All dog exercise equipment is made of galvanised steel and powder coated for extra durability. A variety of powder coated colours available. Stainless Steel could also be used if required. It can be mounted either below or above ground.

- Dimensions**
- Height: 309mm above ground
  - Width: 1197mm
- Materials**
- 40NB steel tubing
- Finishes**
- Galvanised
  - Powdercoated
- Fixings**
- In-ground 270mm
  - or surface mounted with base plate (extra cost incurred)
- Options**
- Variable height and width available on request
  - Stainless steel

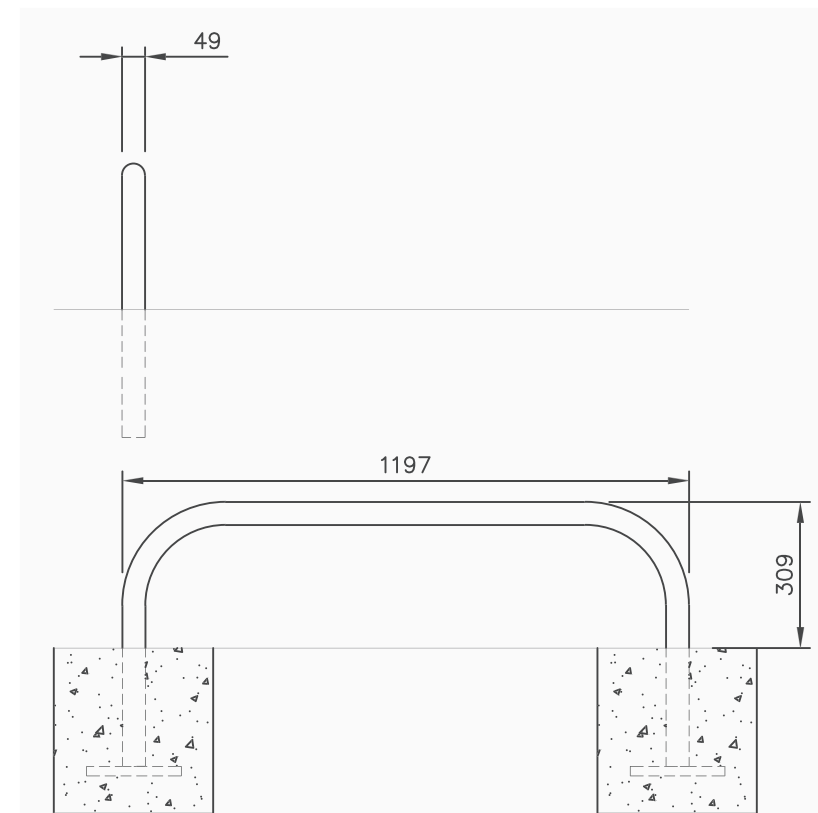

[Click to view the latest Dog Jump projects online](#)



Get the latest specification news on



[www.urbanff.com.au](http://www.urbanff.com.au)

07 3382 7372

[info@urbanff.com.au](mailto:info@urbanff.com.au)

*Urban*  
fountains + furniture

# Dog Play Equipment: Table Dog Ramp

The Table Ramp is part of Urban's extensive range of dog exercise equipment we manufacture for use in off leash areas within City Council Parks. These areas are becoming increasingly popular as Councils recognise the need to provide dog friendly areas within local parks.

All dog exercise equipment is made of galvanised steel and powder coated for extra durability. A variety of powder coated colours available. Stainless Steel could also be used if required. It can be mounted either below or above ground.

- Dimensions**
- Height 872mm
  - Width 495mm
  - Length 3126mm
- Materials**
- Steel RHS frame construction
  - Galvanised sheeting
- Finishes**
- Galvanised, primed and powder coated.
  - External anti slip coating
- Fixings**
- In-ground
  - Surface mounted with base plate (extra cost incurred)
- Options**
- Variable Dimensions available on request

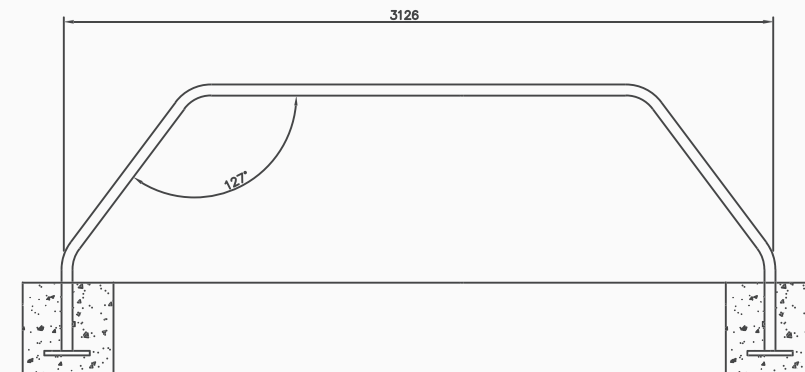
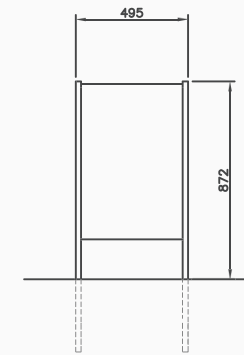

[Click to view the latest Table Ramp projects online](#)



Get the latest specification news on



[www.urbanff.com.au](http://www.urbanff.com.au)

07 3382 7372

info@urbanff.com.au

*Urban*  
fountains + furniture



# Dog Play Equipment: Dog Tunnel

The Dog Tunnel is part of Urban's extensive range of dog exercise equipment we manufacture for use in off leash areas within City Council Parks. These areas are becoming increasingly popular as Councils recognise the need to provide dog friendly areas within local parks.

All dog exercise equipment is made of galvanised steel and powder coated for extra durability. A variety of powder coated colours available. Stainless Steel could also be used if required. It can be mounted either below or above ground.

- Dimensions**
- Height: 723mm
  - Width: 750mm
  - Length: 1520mm
- Materials**
- Steel SHS frame
  - Galvanised sheeting
- Finishes**
- Galvanised, primed and powder coated.
- Fixings**
- In-ground
  - Surface mounted with base plate (extra cost incurred)
- Options**
- Variable height/width/length available on request
  - External anti slip finish available

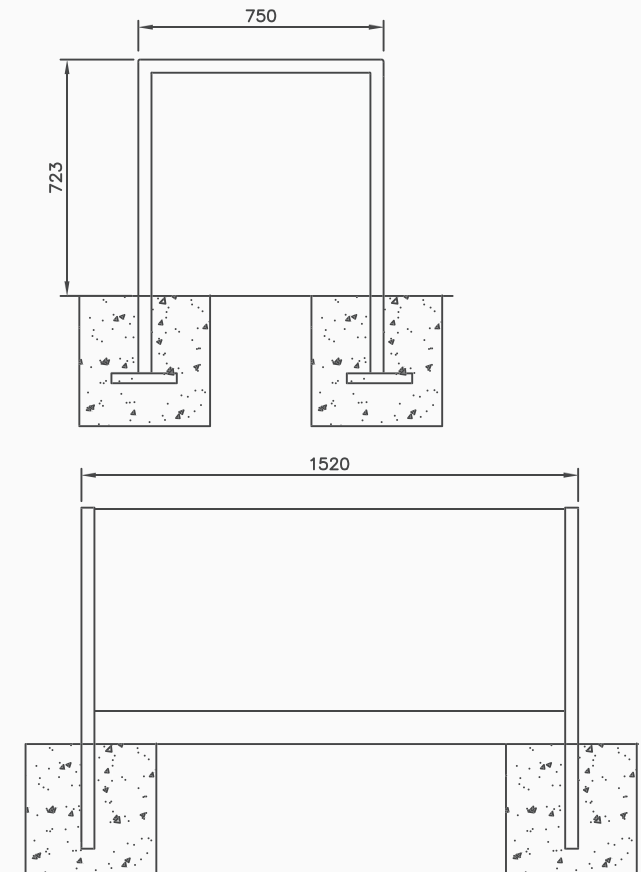

[Click to view the latest Dog Tunnel projects online](#)



Get the latest specification news on



[www.urbanff.com.au](http://www.urbanff.com.au)

07 3382 7372

[info@urbanff.com.au](mailto:info@urbanff.com.au)

*Urban*  
fountains + furniture

# Dog Play Equipment: Weave Poles

Weave Poles are part of Urban's extensive range of dog exercise equipment we manufacture for use in off leash areas within City Council Parks. These areas are becoming increasingly popular as Councils recognise the need to provide dog friendly areas within local parks.

All dog exercise equipment is made of galvanised steel and powder coated for extra durability. A variety of powder coated colours available. Stainless Steel could also be used if required. It can be mounted either below or above ground.

- Dimensions**
  - Height 1023mm above ground
  - 60 OD pipe
- Materials**
  - Galvanised tubing
- Finishes**
  - Galvanised, primed and powder coated
- Fixings**
  - In-ground
  - Surface mounted with base plate (extra cost incurred)
- Options**
  - Variable dimensions available on request

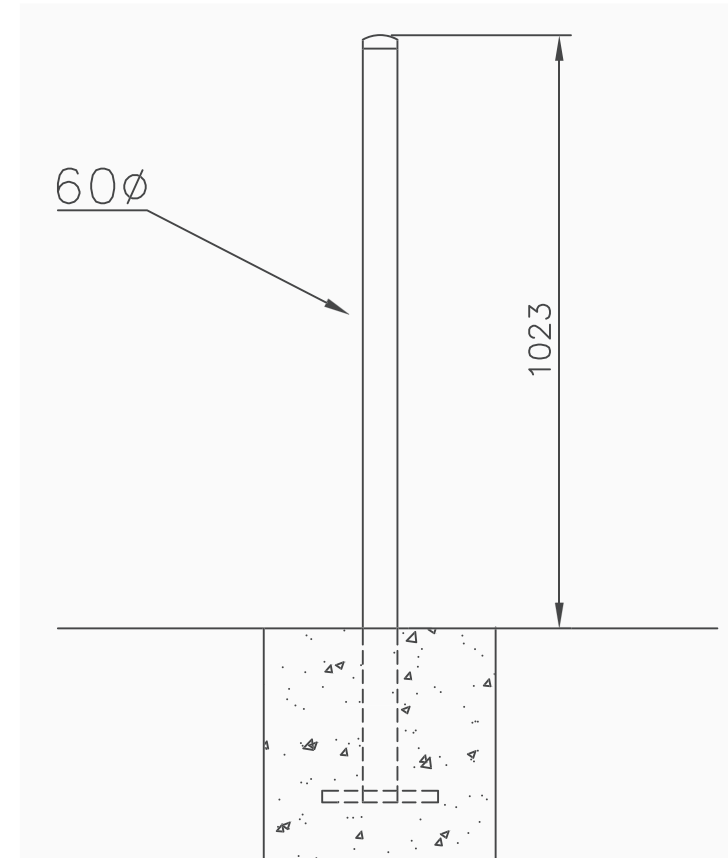

[Click to view the latest Weave Pole projects online](#)



Get the latest specification news on



[www.urbanff.com.au](http://www.urbanff.com.au)

07 3382 7372

[info@urbanff.com.au](mailto:info@urbanff.com.au)

*Urban*  
fountains + furniture



Products // Balustrading



# Balustrading: SS24

The SS24 is a unique set of Stainless Steel Balustrading that can be used in a variety of urban streetscapes that require pedestrian safety, including taxi ranks and suburban centres.

- Dimensions**
- Height: 1200mm
  - Length: 2400mm (variable)
  - 3/4" 304 s/s bars
  - 76mm diameter outside frame
  - 8mm base plate
- Materials**
- 304 Stainless Steel
- Finishes**
- Satin polished stainless finish
- Fixings**
- Surface mounted with Dyna bolts
  - Inground with Foundation cage
- Options**
- Variable length and heights
  - Various designs to your specifications

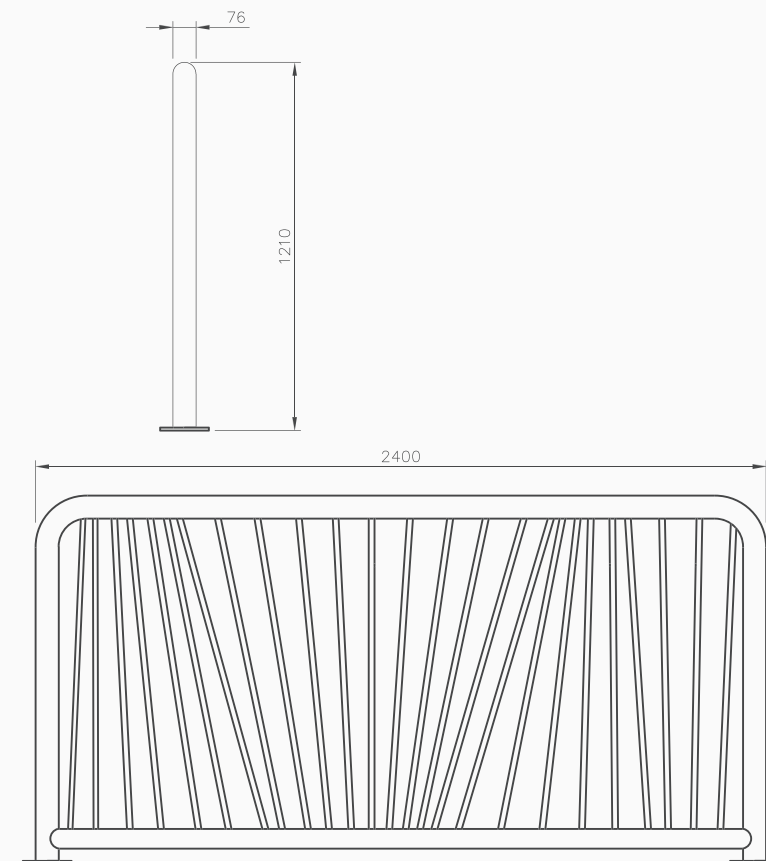

[Click to view the latest Balustrading projects online](#)



Get the latest specification news on



[www.urbanff.com.au](http://www.urbanff.com.au)

07 3382 7372

[info@urbanff.com.au](mailto:info@urbanff.com.au)

*Urban*  
fountains + furniture



# Products // Tree Grates & Paving



# Tree Grate: BCC

Due to an increase in demand for a stronger and more practical tree grate, we manufacture a range of laser cut steel grates for the BCC that are far superior to the aluminium grates currently on the market.

- Dimensions**
- Grate sizes 1594mm x 1594mm & 1191mm x 1594mm
  - Centre cut out 380mm diameter
  - Frame sizes 1613mm x 1613mm & 1211mm x 1612mm

- Materials**
- Laser cut steel plate
  - Steel bar supports
  - BCC Logo

- Finishes**
- ANTI SLIP "W" Rating for footpaths
  - Hot dipped Galvanised
  - Powdercoated in your choice of colour

- Fixings**
- Galvanised angle support frame
  - Quick release cam locks
  - 6mm bolts

- Options**
- Off set tree grates
  - Any size, shape or pattern available on request
  - Variable centre cut out size

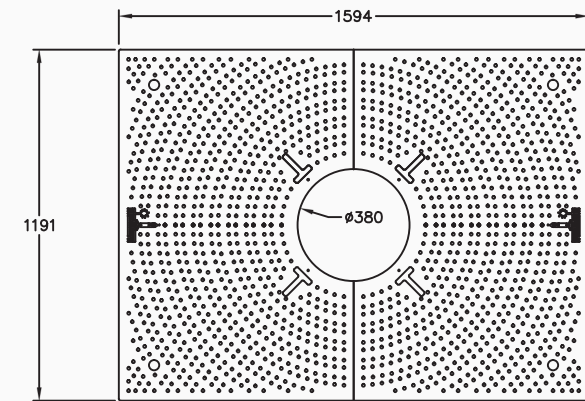

1600 X 1200 GRATE

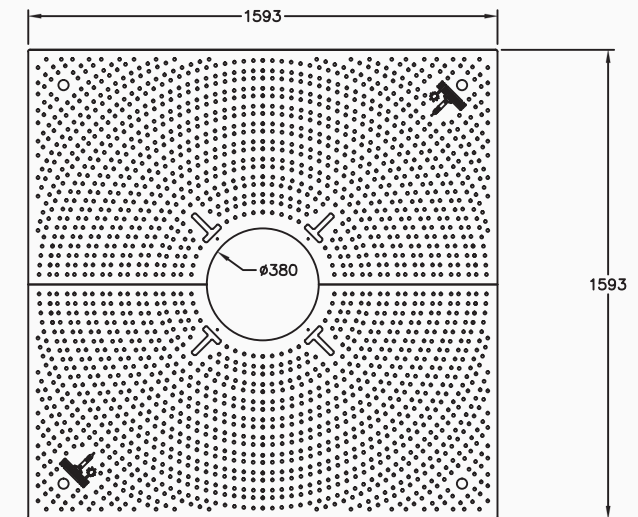

1600 X 1600 GRATE

[Click to view the latest Tree Grate projects online](#)

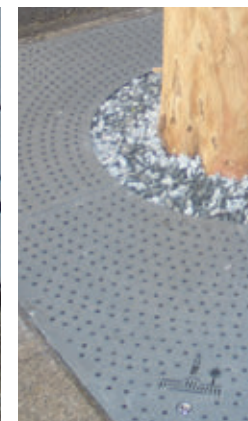

Get the latest specification news on



[www.urbanff.com.au](http://www.urbanff.com.au)

07 3382 7372

info@urbanff.com.au

*Urban*  
fountains + furniture

# Tree Grates: 1200 x 1200

Due to an increase in demand for a stronger and more practical tree grate, we have designed a range of laser cut steel grates that are far superior to the aluminium grates currently on the market.

- Dimensions**
- Grate size: 1191mm x 1191mm
  - Centre cut out: 380mm diameter
  - Frame size: 1121mm x 1121mm
- Materials**
- Laser cut steel plate
  - Steel bar supports
- Finishes**
- ANTI SLIP "W" Rating for footpaths
  - Hot dipped Galvanised
  - Powdercoated in your choice of colour
- Fixings**
- Galvanised angle support frame
  - Quick release cam locks
  - 6mm bolts
- Options**
- Off set tree grates
  - Any size, shape or pattern available on request
  - Variable centre cut out size
  - Logos incorporated
  - Illuminated grates
  - Tree guards

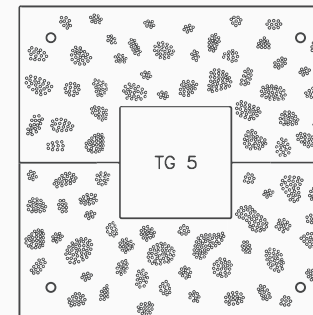
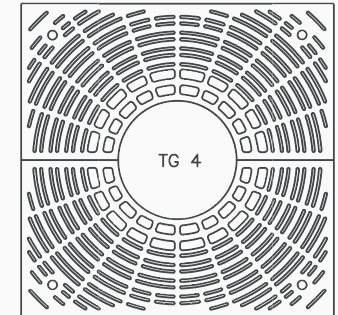
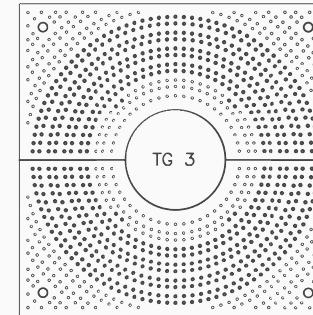
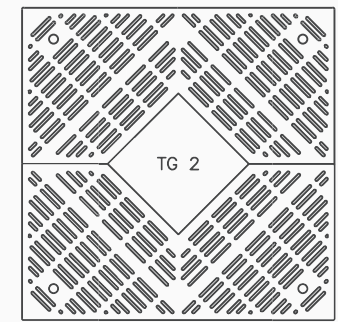
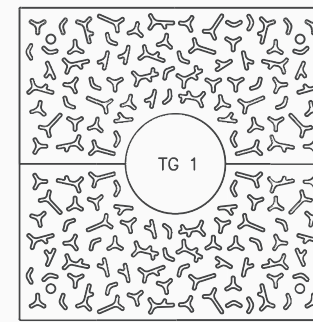

[Click to view the latest Tree Grate projects online](#)

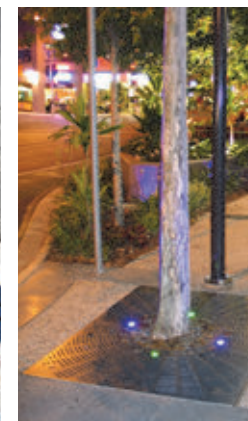

Get the latest specification news on



[www.urbanff.com.au](http://www.urbanff.com.au)

07 3382 7372

[info@urbanff.com.au](mailto:info@urbanff.com.au)

*Urban*  
fountains + furniture

# Tree Grates: 1600 x 1600

Due to an increase in demand for a stronger and more practical tree grate, we have designed a range of laser cut steel grates that are far superior to the aluminium grates currently on the market.

- Dimensions**
  - Grate size: 1593 x 1593mm
  - Centre cut out: 380mm
  - Frame size: 1613mm x 1613mm
- Materials**
  - Laser cut steel plate
  - Steel bar supports
- Finishes**
  - ANTI SLIP "W" Rating for footpaths
  - Hot dipped Galvanised
  - Powdercoated in your choice of colour
- Fixings**
  - Galvanised angle support frame
  - Quick release cam locks
  - 6mm bolts
- Options**
  - Off set tree grates
  - Any size, shape or pattern available on request
  - Variable centre cut out size
  - Logos incorporated
  - Illuminated grates
  - Tree guards

[Click to view the latest Tree Grate projects online](#)

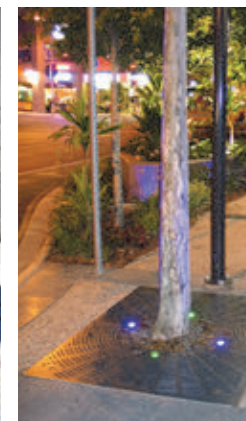
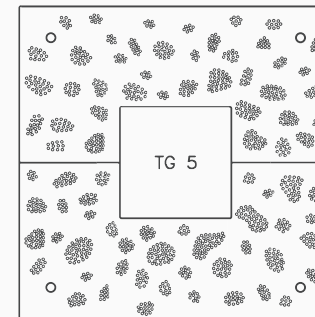
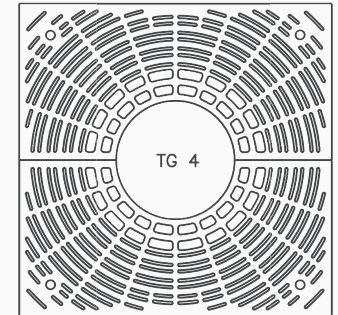
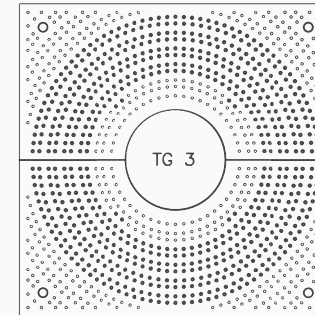
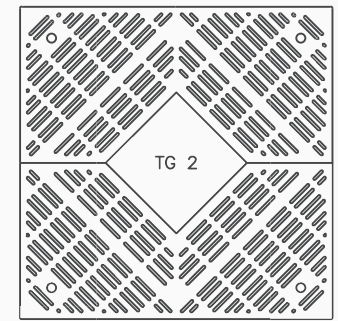
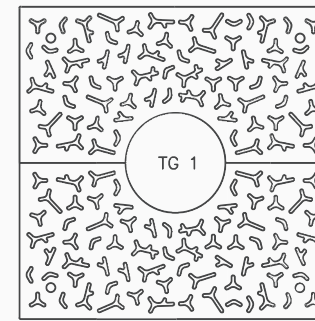

Get the latest specification news on



[www.urbanff.com.au](http://www.urbanff.com.au)

07 3382 7372

[info@urbanff.com.au](mailto:info@urbanff.com.au)

*Urban*  
fountains + furniture



# Tree Grates: Custom

By using Auto CAD technology, Urban can design and reproduce almost any shape or pattern imaginable beyond the basic styles illustrated. A laser cut logo or motif can be added to create an individual look or theme for an urban streetscape or uniformity throughout a Council Shire.

- Dimensions**
  - Grate size – Any size available
  - Centre cut out – 200mm – 600mm available
  - Frame size – Any size to suit your application
- Materials**
  - Laser cut steel plate
  - Steel bar supports
- Finishes**
  - ANTI SLIP “W” Rating for footpaths
  - Hot dipped Galvanised
  - Powdercoated in your choice of colour
- Fixings**
  - Galvanised angle support frame
  - Quick release cam locks
  - 6mm bolts
- Options**
  - Off set tree grates
  - Any size, shape or pattern available on request
  - Variable centre cut out size
  - Logos incorporated
  - Illuminated grates
  - Tree guards

[Click to view the latest Tree Grate projects online](#)

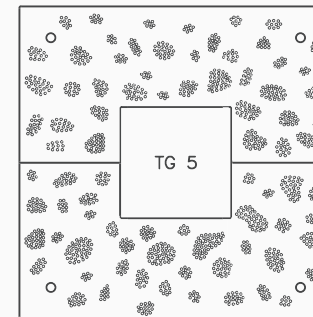
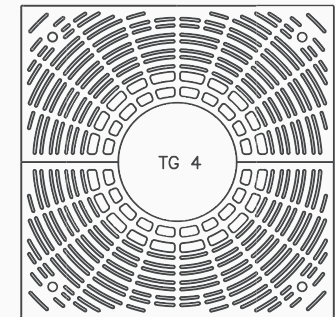
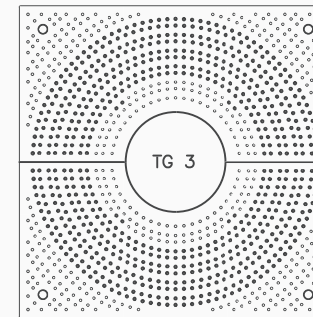
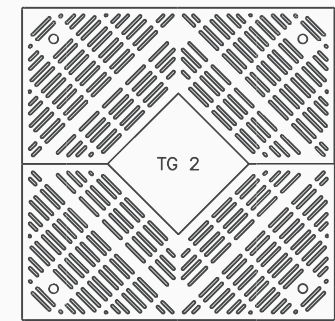
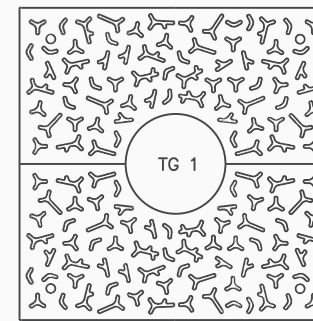

Get the latest specification news on



[www.urbanff.com.au](http://www.urbanff.com.au)

07 3382 7372

info@urbanff.com.au

*Urban*  
fountains + furniture

# Tree Grates: Offset

For existing trees planted at unusual distances from the curb, Urban can supply individually profiled cut grates modified from the illustrated patterns to suit any application. In the past trees that were planted at unequal distances from the gutter were unable to receive an aluminium or cast iron grate. However, the use of our split tree grate frames allow our grates to be fitted around existing trees.

- Dimensions**
- Grate size: Any size available
  - Centre cut out: 200mm – 600mm available
  - Frame size: Any size to suit your application
  - Split Frames to suit existing trees
- Materials**
- Laser cut steel plate
  - Steel bar supports
- Finishes**
- ANTI SLIP “W” Rating for footpaths
  - Hot dipped Galvanised
  - Powdercoated in your choice of colour
- Fixings**
- Galvanised angle support frame
  - Quick release cam locks
  - 6mm bolts
- Options**
- Any size, shape or pattern available on request
  - Logos incorporated
  - Illuminated grates
  - Tree guards

[Click to view the latest Tree Grate projects online](#)

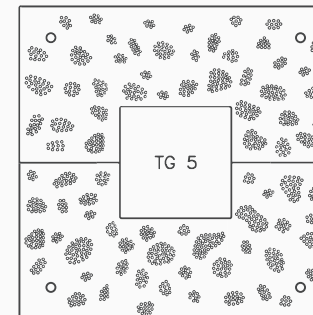
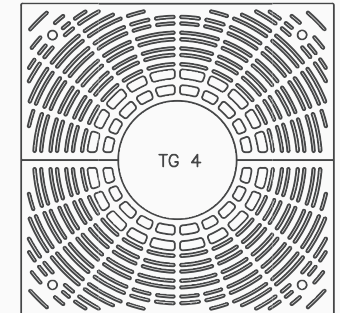
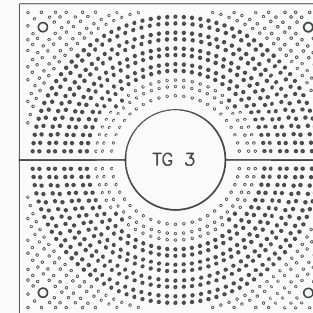
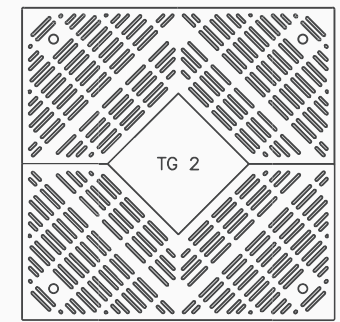
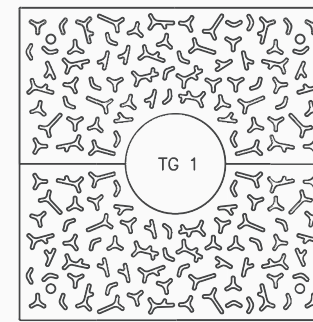

Get the latest specification news on



[www.urbanff.com.au](http://www.urbanff.com.au)

07 3382 7372

[info@urbanff.com.au](mailto:info@urbanff.com.au)

*Urban*  
fountains + furniture

# Tree Grates: Square & Rectangular

Due to an increase in demand for a stronger and more practical tree grate, we have designed a range of laser cut steel grates that are far superior to the aluminium grates currently on the market.

- Dimensions**
- Grate sizes: 1200mm x 1200mm, 1200mm x 1600mm, 1600mm x 1600mm
  - Centre cut out: 380mm
  - Custom sized and styled Tree Grates also available

- Materials**
- Laser cut steel plate
  - Steel bar supports

- Finishes**
- ANTI SLIP "W" Rating for footpaths
  - Hot dipped Galvanised
  - Powdercoated in your choice of colour

- Fixings**
- Galvanised angle support frame
  - Quick release cam locks
  - 6mm bolts

- Options**
- Off set tree grates
  - Any size, shape or pattern available on request
  - Variable centre cut out size
  - Logos incorporated
  - Illuminated grates
  - Tree guards

[Click to view the latest Tree Grate projects online](#)

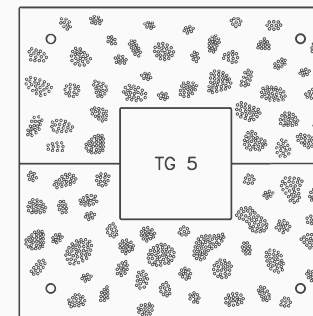
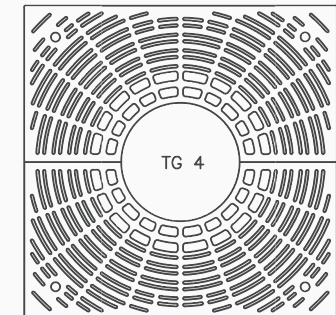
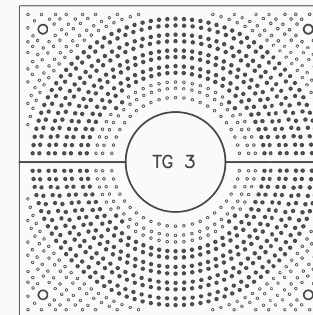
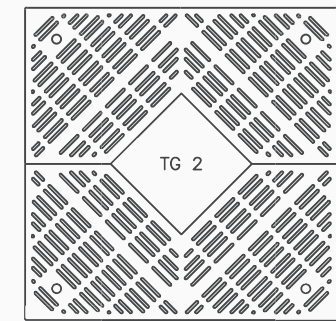
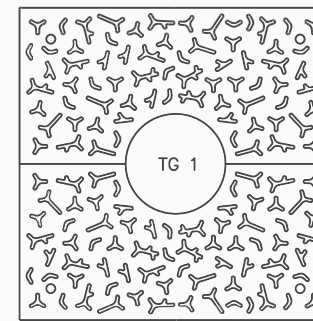

Get the latest specification news on



[www.urbanff.com.au](http://www.urbanff.com.au)

07 3382 7372

[info@urbanff.com.au](mailto:info@urbanff.com.au)

*Urban*  
fountains + furniture

# Tree Surround: BCC

Manufactured exclusively for the Brisbane City Council, these tree surrounds are the perfect accompaniment for BCC's range of tree grating. In addition to providing protection for new trees, they provide great decorative detail.

- Dimensions**
- Height: 1250mm
  - Diameter: 720mm
- Materials**
- Cast aluminium tree spears
  - Galvanised steel mesh
  - Aluminium angled mounting brackets
- Finishes**
- Hot dipped Galvanised
  - Powdercoated in your choice of colour
- Fixings**
- 6mm bolts and nuts

[Click to view the latest Tree Surround projects online](#)

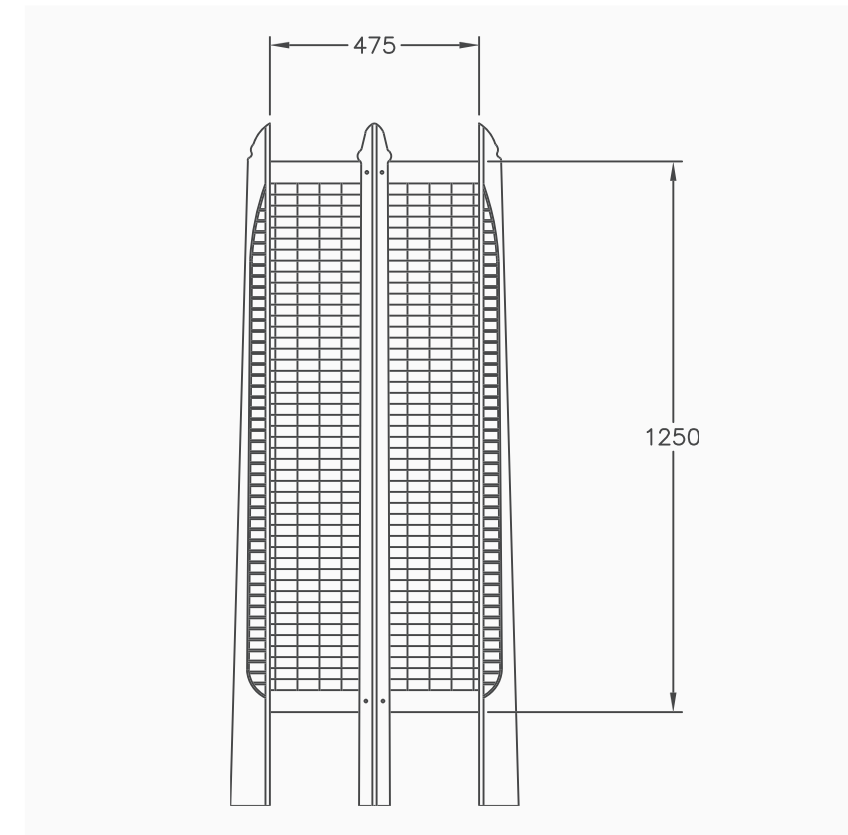

Get the latest specification news on



[www.urbanff.com.au](http://www.urbanff.com.au)

07 3382 7372

[info@urbanff.com.au](mailto:info@urbanff.com.au)

*Urban*  
fountains + furniture

# “Soak Thru” Porous Paving

Soak Thru is a safe bonded aggregate that provides a viable and aesthetically pleasing alternative to traditional tree grates. It's an innovative and economical paving system designed to filter water through to the underlying media. Soak Thru porous paving is virtually maintenance free and there is no back filling required.

The paving is designed to withstand the normal loads associated with pedestrian and light vehicular traffic. The Soak Thru paving is also ideal for tree grate application. It can be installed directly around the tree (preferred method of application) or into a frame\* to make porous paving removable.

\*Please note that some restrictions in use will apply by utilising this method.

## Features & Benefits

- Minimises trip hazards
- Stops unsightly litter / cigarette butt collection
- Safe non slip surface – Tested in accordance with AS/NZS 4586:1999 Standard.
- Water filters quickly through to tree roots and subsoil – Tested in accordance with AS/NZS 4456.16:1997 – 4673mls per minute.
- Installed by experienced installers on site
- System can be tailored to suit your individual application
- Variety of aggregate finishes available
- Growth rings can be inserted to account for tree growth
- Logo or Motif can be incorporated into finished grate



Riverina Red



Denman Red



Black



Cowra White



Cowra Gold

[Click to view the latest Porous Paving projects online](#)



Get the latest specification news on



[www.urbanff.com.au](http://www.urbanff.com.au)

07 3382 7372

[info@urbanff.com.au](mailto:info@urbanff.com.au)

*Urban*  
fountains + furniture

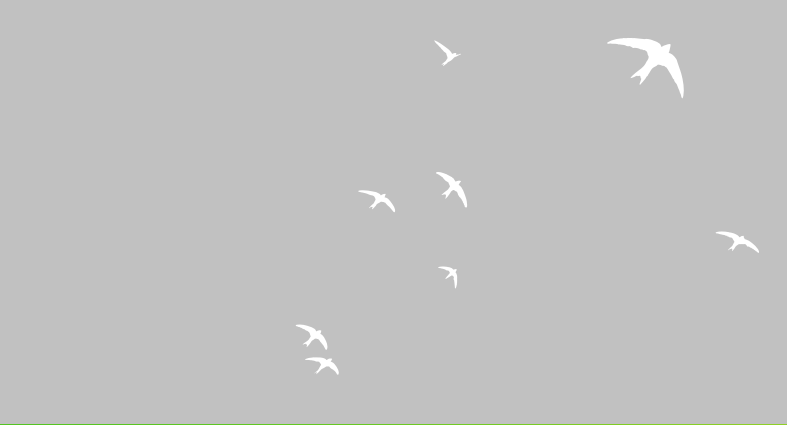

# Products // Bike Racks



# Bike Rack: BCC

The BCC bike rack is a simple and unobtrusive way of both providing a facility to secure pushbikes. It is also useful in doubling to provide a visual barricade to clearly delineate an urban space.

- Dimensions**
- Height: 800mm
  - Width: 900mm
  - 760D tubing
- Materials**
- Aluminium tubing
  - Cast aluminium base plates
- Finishes**
- Powdercoated in your choice of colour
- Fixings**
- 10mm Dyna bolts

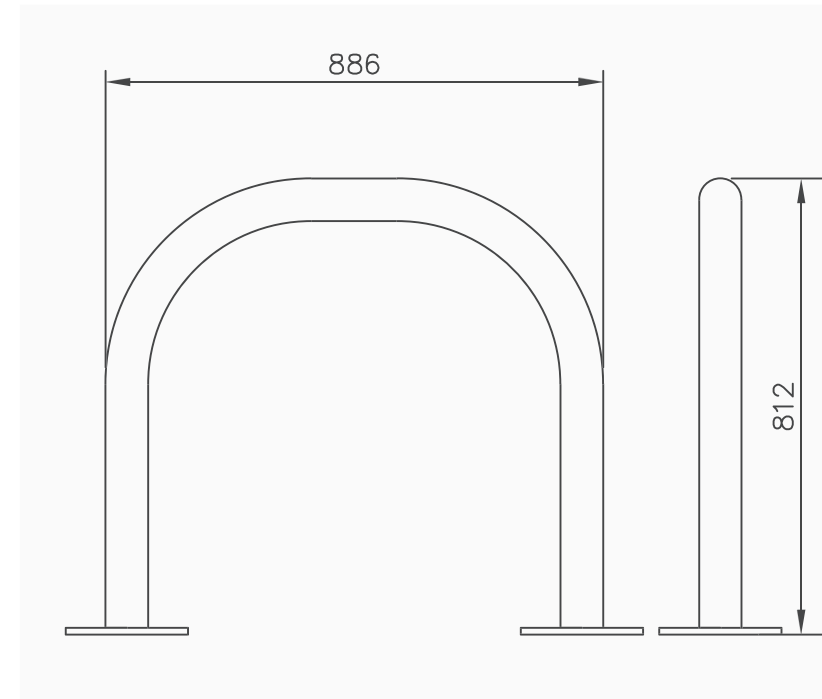

[Click to view the latest Bike Rack projects online](#)



Get the latest specification news on



[www.urbanff.com.au](http://www.urbanff.com.au)

07 3382 7372

[info@urbanff.com.au](mailto:info@urbanff.com.au)

*Urban*  
fountains + furniture



## // Contact UrbanFF

Phone 07 3382 7372

Fax 07 3287 5598

Email [info@urbanff.com.au](mailto:info@urbanff.com.au)

Street 5 Telford Circuit Yatala Q 4207 Australia

Get the latest specification news on



[pinterest.com/urbanff](https://pinterest.com/urbanff)



[gplus.to/urbanff](https://gplus.to/urbanff)



[facebook.com/urbanff](https://facebook.com/urbanff)

[urbanff.com.au](http://urbanff.com.au)



